

secco

SPEEDY



CATALOGO TECNICO

Dicembre 2003

PROFILI FINESTRA

(Sistema da pag.1 a pag.20)

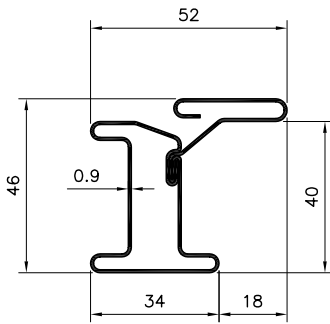

P.4527

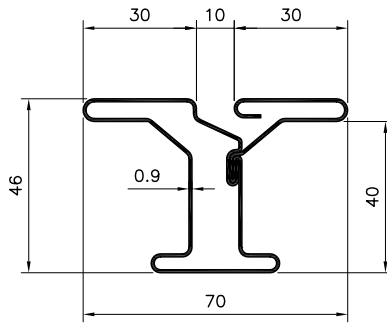

P.4528

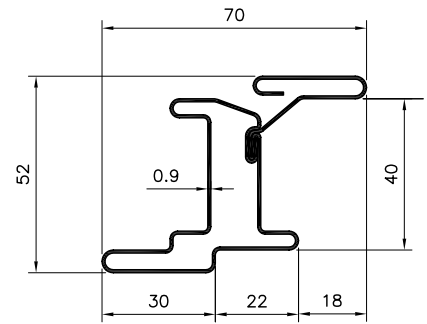

P.4544

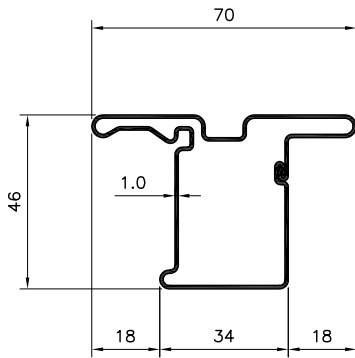

P.4171

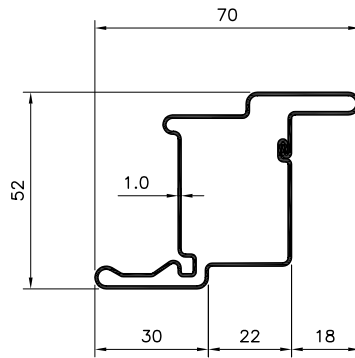

P.4170

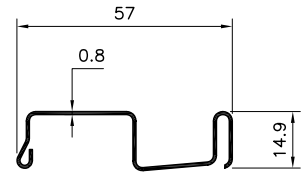

P.4529

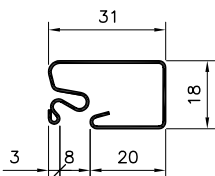

P.4179

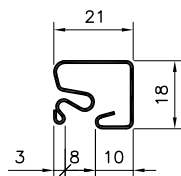

P.4180

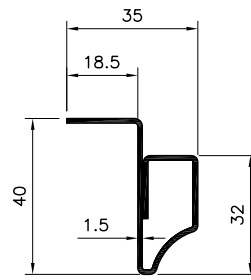

P.0903

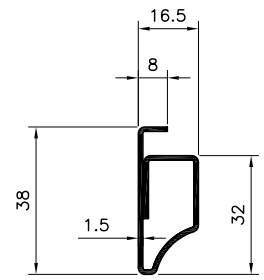

P.0911

PROFILI PORTA

(Sistema da pag.21 a pag.40)

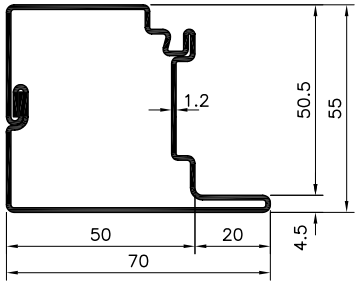

P.2011

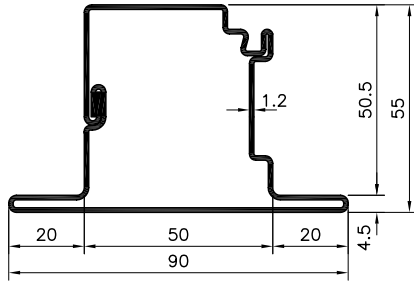

P.2012

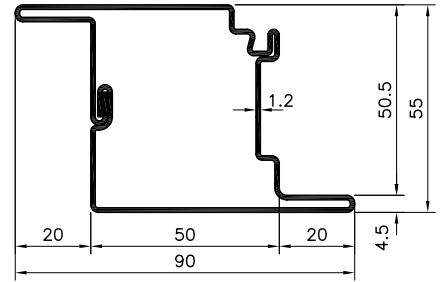

P.2013

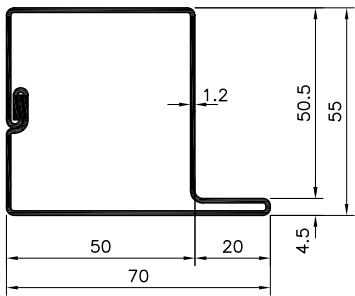

P.2001

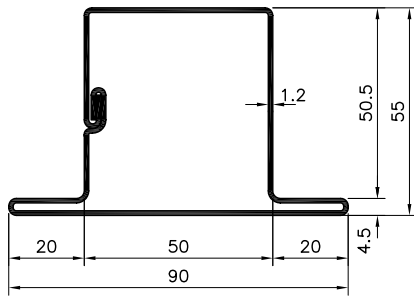

P.2002

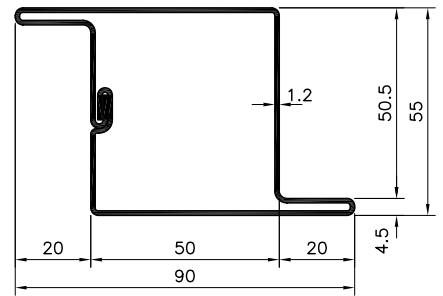

P.2003

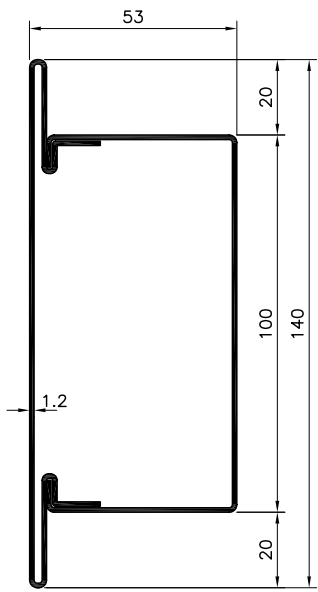

P.2004

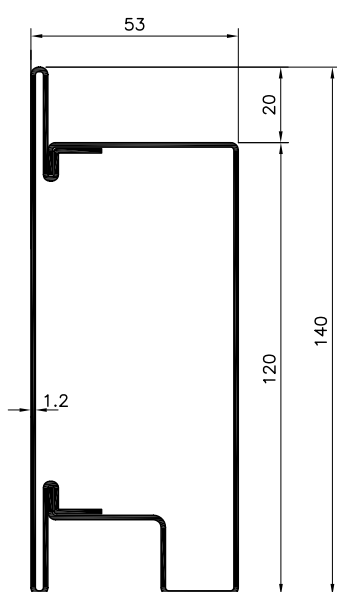

P.2005

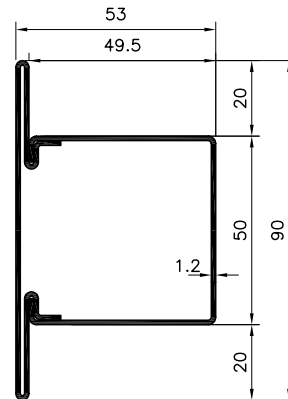

P.2014

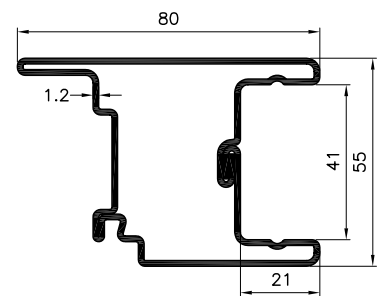

P.2201

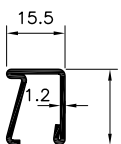

P.2007

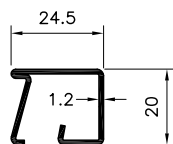

P.2008

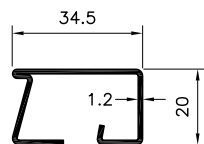

P.2009

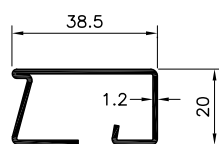

P.2010

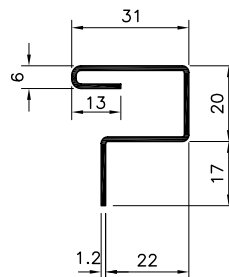

P.2218

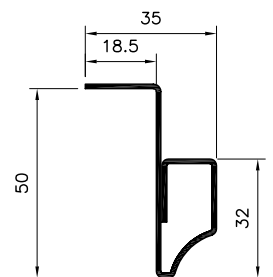

P.0905

P.4527

A	cm ²	2.35
P	kg/m	1.77
Jx	cm ⁴	3.59
Jy	cm ⁴	5.81
Wx	cm ³	1.40
Wy	cm ³	1.92

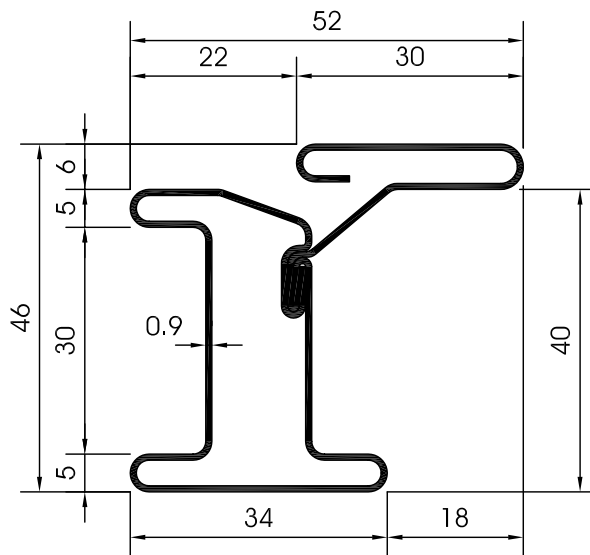

P.4528

A	cm ²	2.69
P	kg/m	2.04
Jx	cm ⁴	6.96
Jy	cm ⁴	6.60
Wx	cm ³	1.94
Wy	cm ³	2.34

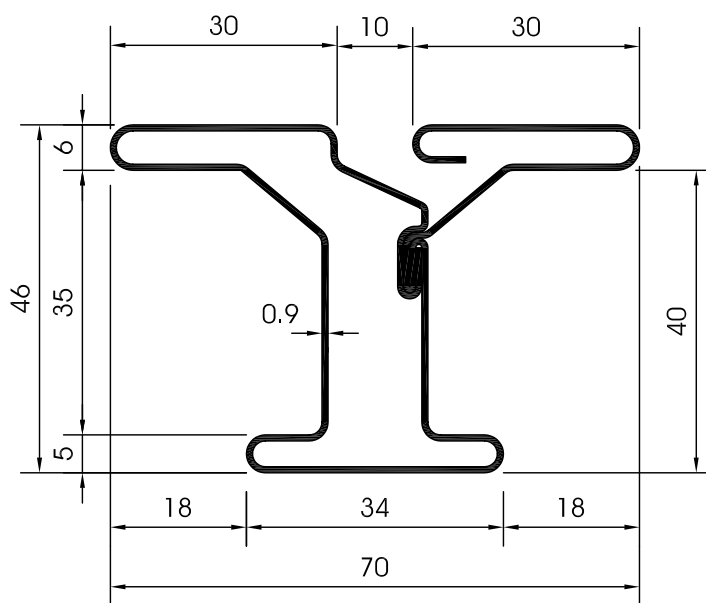

P.4544

A	cm ²	2.74
P	kg/m	2.07
Jx	cm ⁴	8.88
Jy	cm ⁴	6.88
Wx	cm ³	2.49
Wy	cm ³	2.44

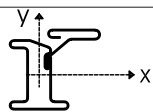
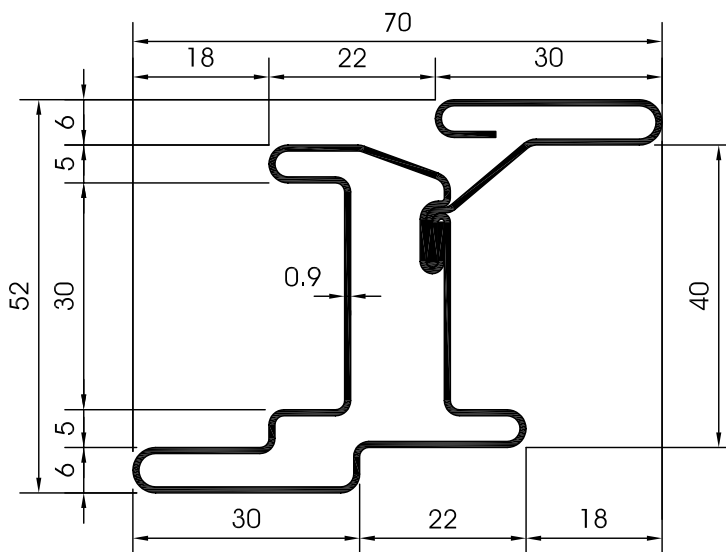

A = area della sezione
P = massa teorica
Jx = momento d'inerzia baricentrico, asse x
Jy = momento d'inerzia baricentrico, asse y

Wx = momento resistente baricentrico, asse x
Wy = momento resistente baricentrico, asse y

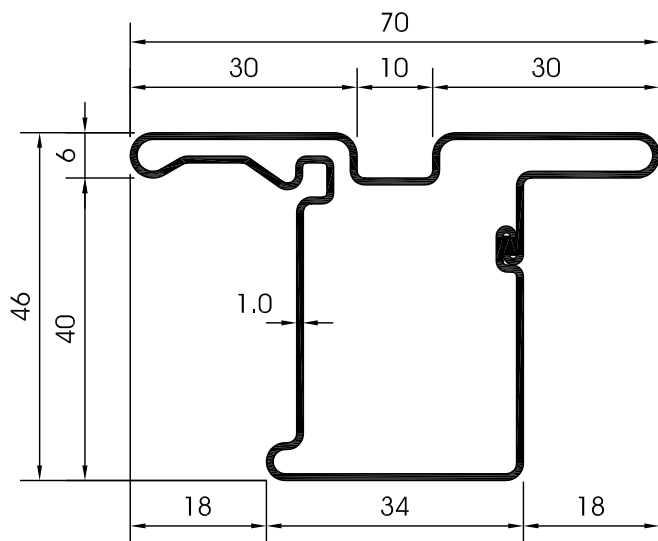

P.4171	
A cm ²	2.64
P kg/m	2.04
Jx cm ⁴	7.02
Jy cm ⁴	8.48
Wx cm ³	1.98
Wy cm ³	2.83

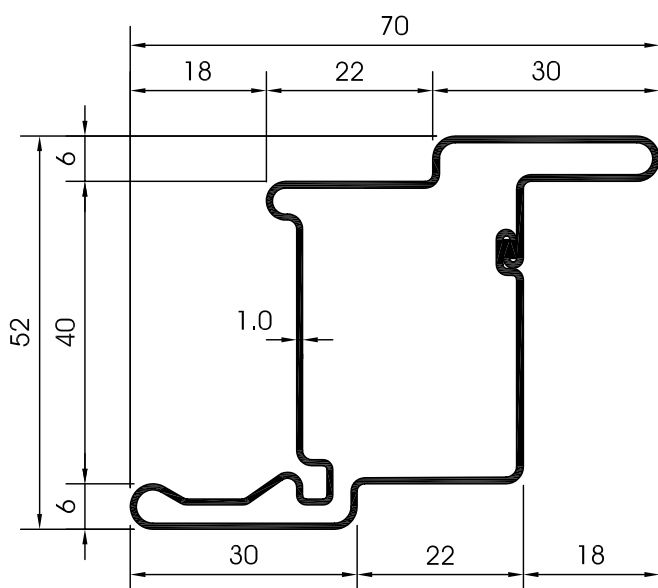

P.4170	
A cm ²	2.63
P kg/m	2.04
Jx cm ⁴	9.62
Jy cm ⁴	8.42
Wx cm ³	2.70
Wy cm ³	3.17

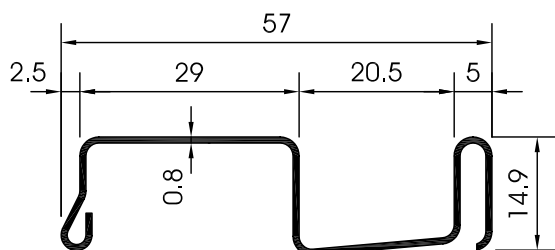

P.4529	
A cm ²	0.90
P kg/m	0.62

SPEEDY

SECCO

P.4179

A cm ²	0.76
P kg/m	0.52

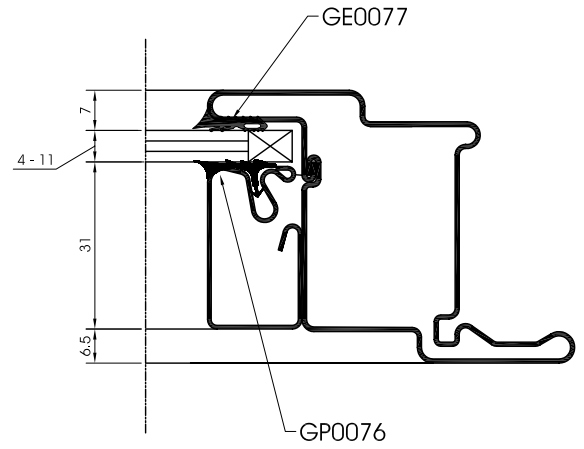
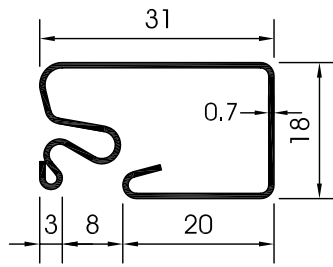

P.4180

A cm ²	0.63
P kg/m	0.42

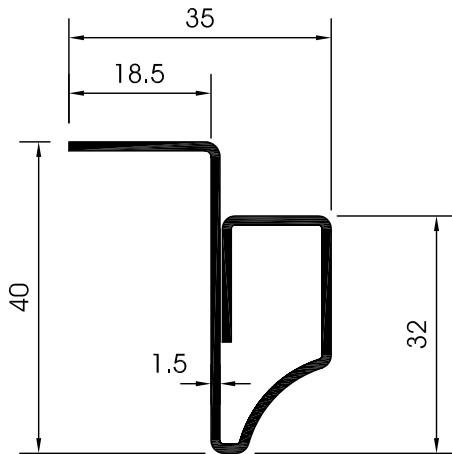
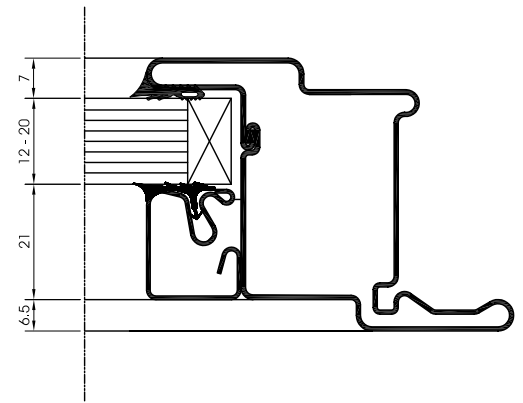
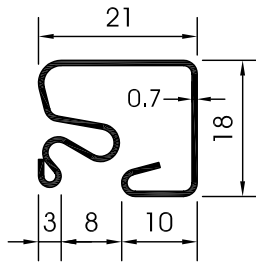

P.0903

A cm ²	1.89
P kg/m	1.42

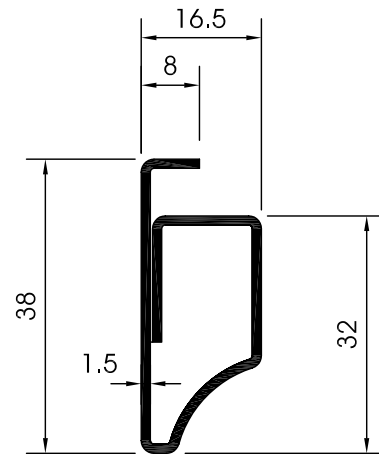

P.0911

A cm ²	1.66
P kg/m	1.25

SPEEDY

SECCO

**AC 4037**

Maniglia a tavellino per apertura a sporgere.
 (Completo di n° 2 viti TPS 4.2x16, n°2 TPS 3.5x13, n° 2 TSC M5x16, n° 2 TSC M5x20)

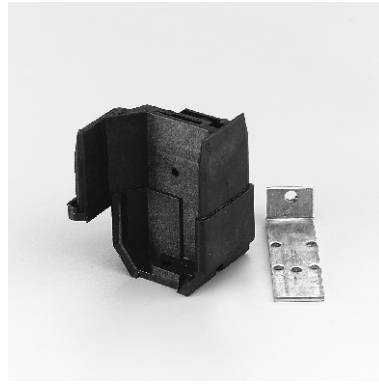
**AC 4253**

SX Fondino per assiemaggio trasverso intermedio P.4528, su P.4527, P.4528 e P.4544.
 (Completo di n° 2 viti TC 4.2x12.7 e n° 2 viti TP 4.2x15.9)

AC 4254

DX

**AC 4040**

Cricchetto da avvitare in lega e nylon nero con incontro in acciaio inox verniciato nero per soluzione complanare.
 (Completo di n° 2 viti TP 3.9x12.7 e n° 2 viti TC 4.8x16)

AC 4040S

Soluzione a sormonto.

**AC 4259..**

Fondino ambidestro per assiemaggio trasverso P.4528 su P.4527, P.4528, P.4544.
 (Completo di n°3 viti TC 4.2x20)

Ac4259 : zincato
 AC4259V : verniciato

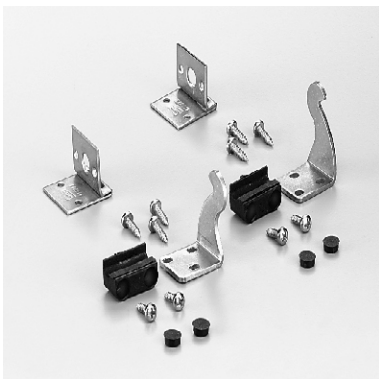
**AC 4226**

Coppia limitatori per piccole aperture a vasistas.
 (Completo di n°4 viti TC 4.2x19 e n°4 viti TC 3.5x9.5)

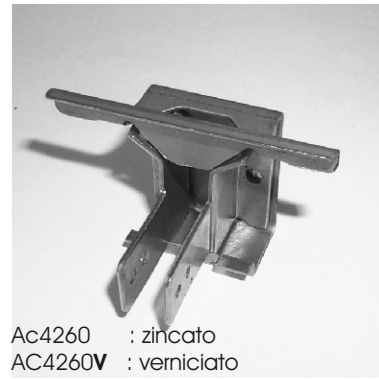
**AC 4260..**

Fondino ambidestro per assiemaggio trasverso intermedio P.4528 su P.4170 e P.4171.
 (Completo di n°3 viti TC 4.2x20)

Ac4260 : zincato
 AC4260V : verniciato

**AC 4246**

SX Fondino per vaschetta raccogli-condensa P. 4529.
 (Completo di n°2 viti TC 4.2x16)

**AC 4265**

Incontro asta cremonese su: P. 4527 - P. 4528 - P. 4544.
 (Completo di n° 1 vite autofilettante TC 3.9x9.7)

**AC 4247**

DX Fondino per vaschetta raccogli-condensa P. 4529.
 (Completo di n°2 viti TC 4.2x16)

**AC 4271**

SX Fondino per inversione battuta.

AC 4272

DX

SPEEDY

SECCO

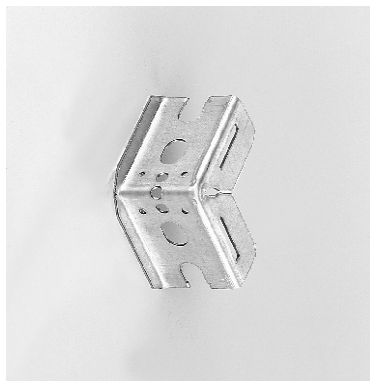

AC 4274

Squadretta d'angolo per assiemaggio telaio esterno
P. 4527 - P. 4528 - P. 4544.
(Completa di n° 4 viti TC 3.5x9.5)

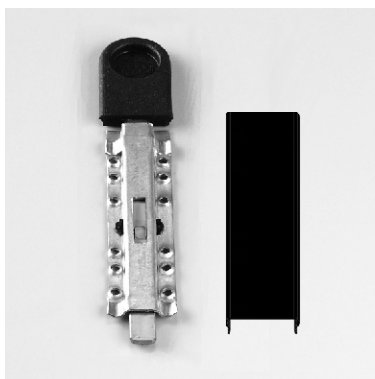

AC 4326

Catenaccio con copertina verniciata nera.
(Completo di n° 4 viti TSP3.5x15.9)



AC 4327

Inox AISI 304
Coppia di guide a compasso per aperture a vasistas con anta peso max 30kg; altezza telaio da min. 300 a max. 1300 mm.
(Completo di n°12 viti TC 4.8x13)



AC 4328

Inox AISI 304
Coppia di guide a compasso per aperture a vasistas con anta peso max 50 kg; altezza telaio da min. 500 a max. 1400 mm.
(Completo di n°12 viti TC 4.8x13 Inox)



AC 4329

Inox AISI 304
Coppia di guide a compasso per aperture a sporgere con anta peso max 30 kg; altezza telaio da min. 400 a max. 1200 mm.
(Completo di n°12 viti TC 4.8x13 Inox)



AC 4330

Inox AISI 304
Coppia di guide a compasso per aperture a sporgere con anta peso max 50 kg; altezza telaio da min. 800 a max. 1400 mm.
(Completo di n°12 viti TC 4.8x13 Inox)



AC 4345

Incontro per gancio cremonese telaio esterno 3^ chiusura su P. 4527 P. 4528 - P. 4544.
(Completo di n° 1 vite TC 3.5x9.5)



AC 4346

Incontro per gancio cremonese telaio interno P.4171.
(Completo di n° 1 vite TC 3.5x9.5)



AC 4350
Cerniera in alluminio verniciata nera per soluzione complanare. (Completo di n°2 viti TP 4.8x25 e n°2 viti TPS M5x10)

AC 4350S
Soluzione a sormonto.



AC 4386
Gocciolatoio di scarico per apertura esterna su P. 4527 - P. 4528 - P. 4544. (Completo di n° 2 viti TC 3.9 x 12.7)

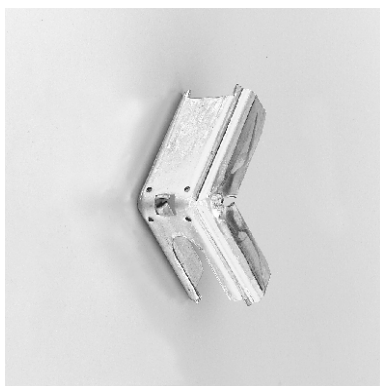

AC 4356
Squadretta d'angolo per assiemaggio telaio interno P. 4170 - P. 4171. (Completa di n° 4 viti TC 3.5x9.5)



AC 4388
SX Cremonese per triplice chiusura. (Completo di n°2 viti TCEI M5x18)

AC 4389
DX

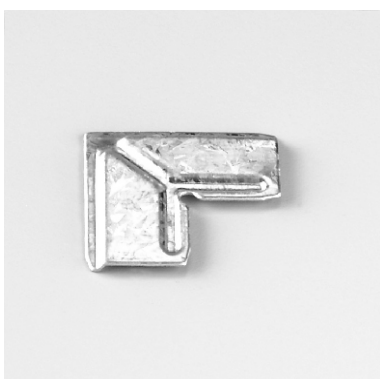

AC 4371
Squadretta per allineamento del battente d'angolo telai interni P. 4170 - P. 4171.

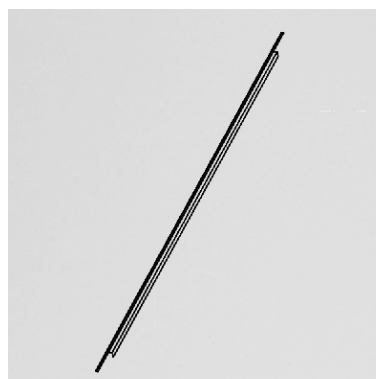

AC 4390
Asta per meccanismo cremonese. L=2000mm



AC 4372
Squadretta di allineamento per telai interni ed esterni P. 4527 - P. 4528 - P. 4544 - P. 4170 - P. 4171.



AC 4415
Fondino per fianco telaio esterno P. 4544 in battente con P. 4529

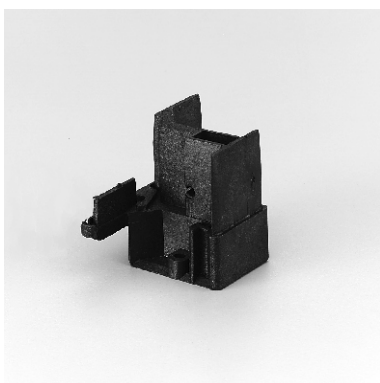

AC 4373
SX Fondino per assiemaggio trasverso P. 4528 intermedio su profili con superficie piana P. 4170 - P. 4171. (Completo di n°3 viti TC 4.2x20)

AC 4374
DX



AC 4416
Fondino per fianco telaio esterno P. 4544 in battente con aperture esterne



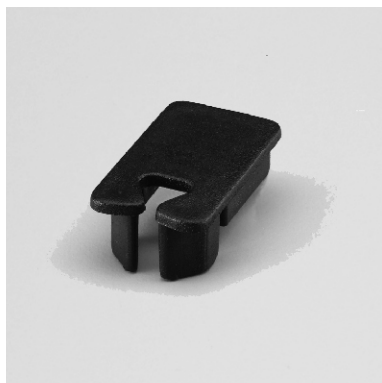

AC 4450

Fondino per
fermavetro
P. 4179 vetro
normale



GE 0069

Guarnizione di
battuta per telai
interni.



AC 4451

Fondino per
fermavetro
P. 4180 vetro isolante

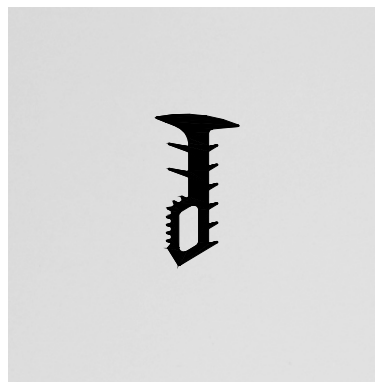

GE 0077

Guarnizione esterna
vetro.

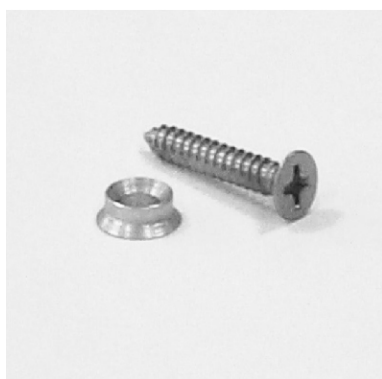

AC 4452

Rondella di
aggancio
fermavetro.

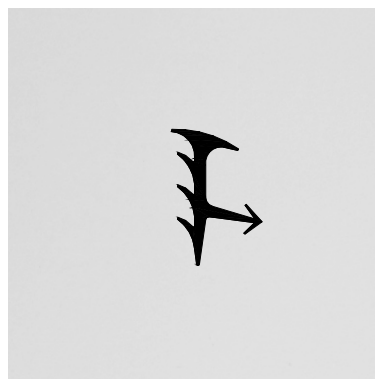

GP 0076

Guarnizione interna
per fermavetro a
scatto P.4179 e
P.4180



AC 4453

Blocchetto per
fissaggio fermavetro
su P. 4527 - P. 4528 -
P. 4544

LISTA TIPOLOGIE PER FINESTRE

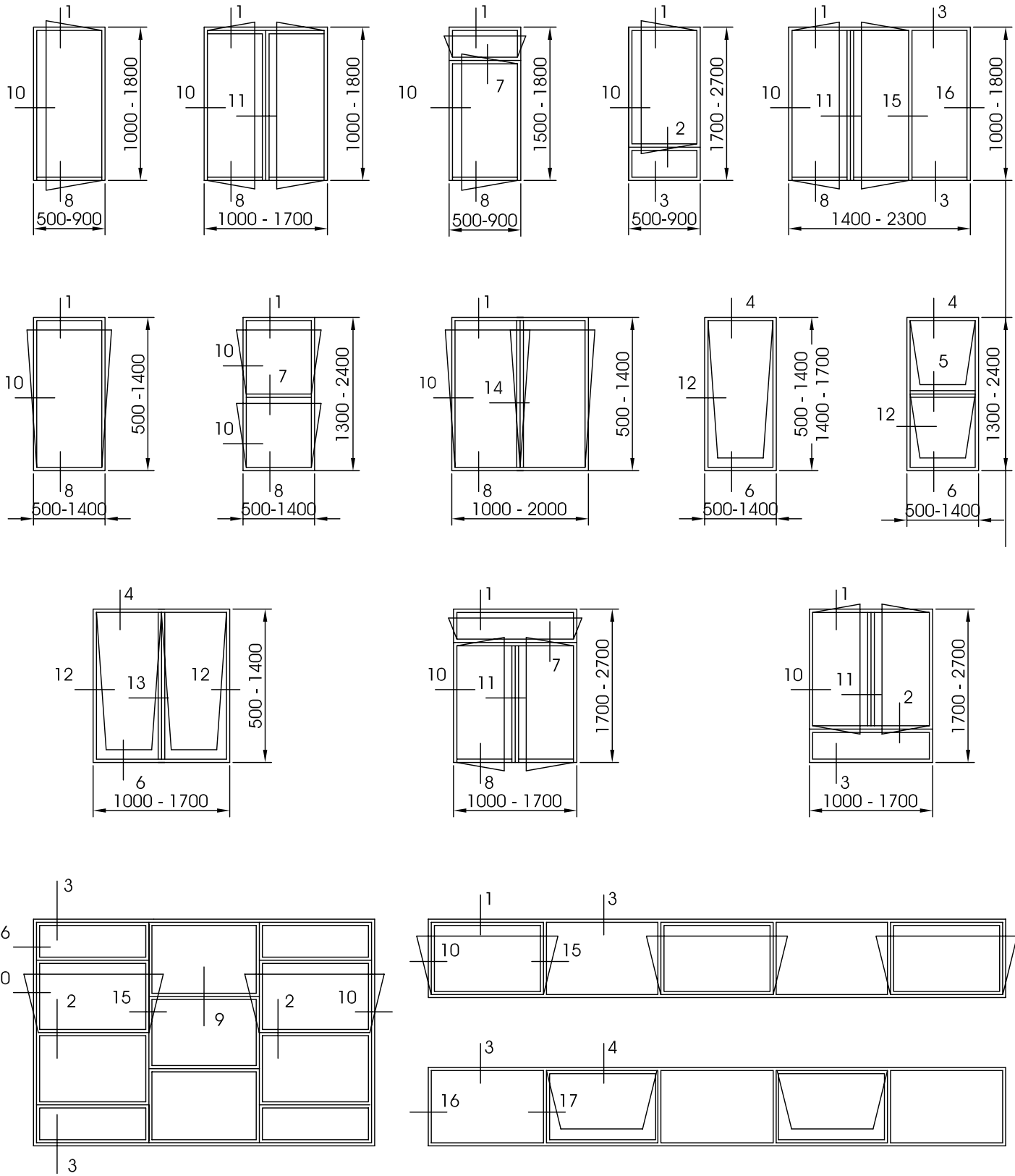

SECCO
SPEEDY

SEZIONI VERTICALI

SPEEDY

SECCO

1

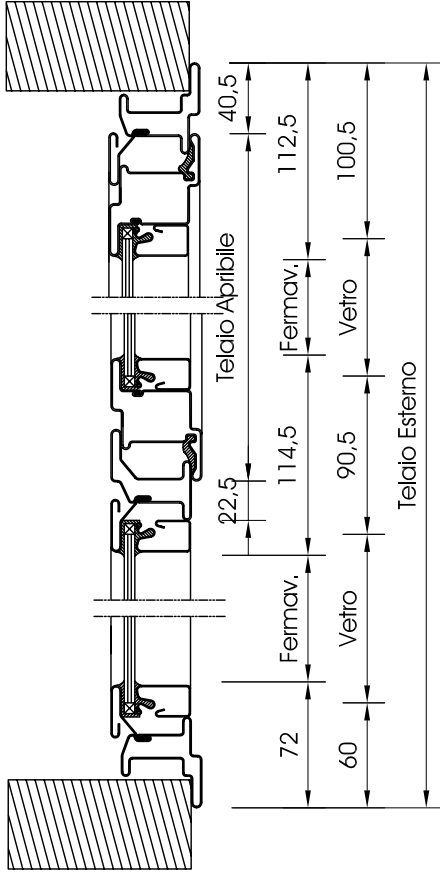

2

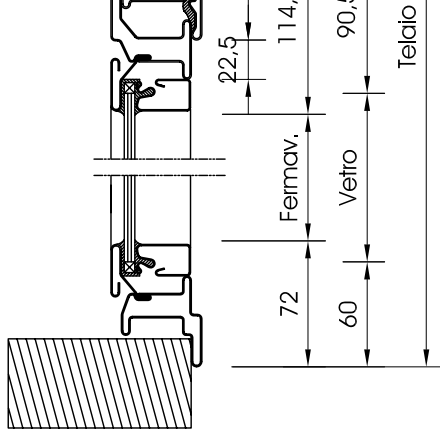

3

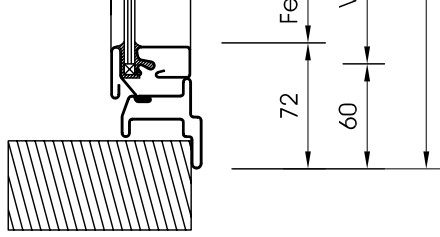

1

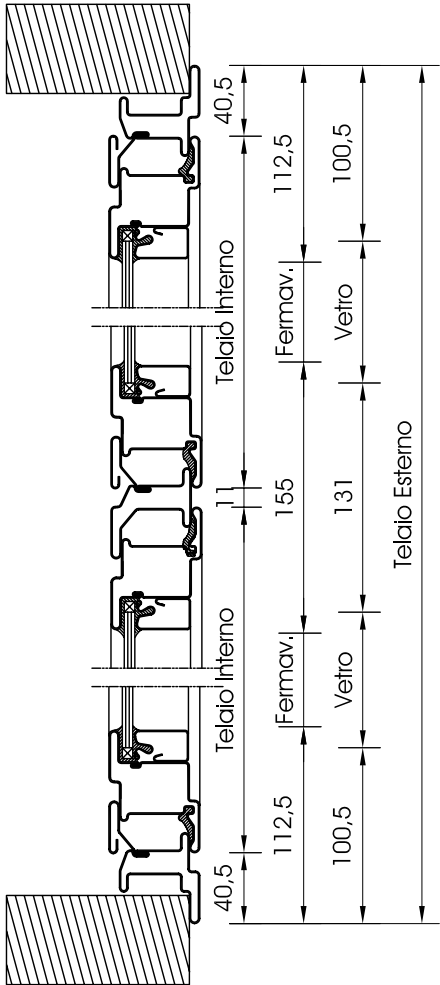

7

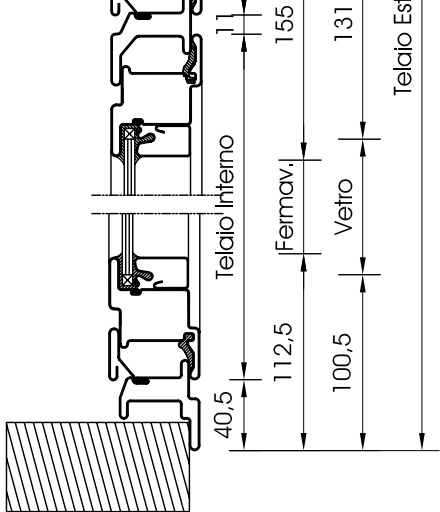

8

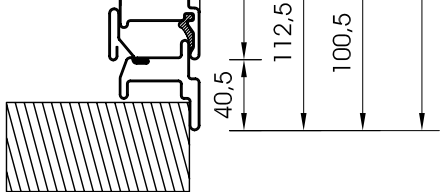

4

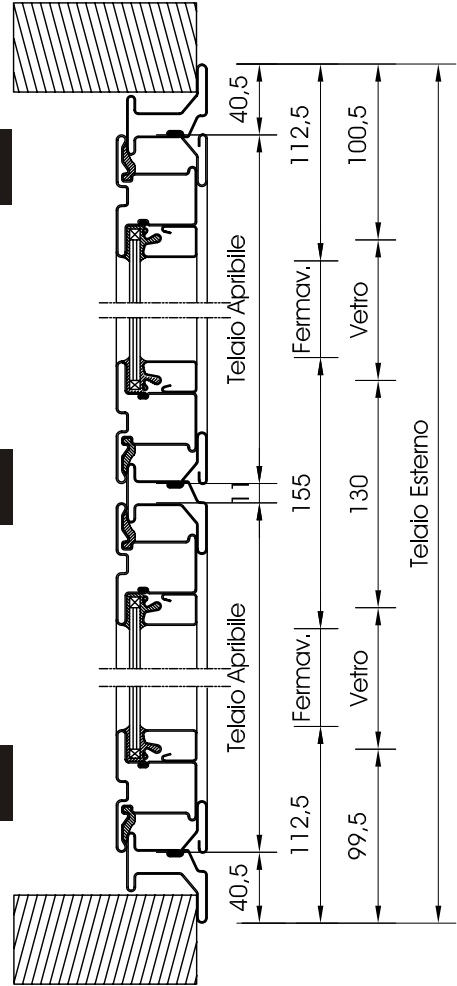

5

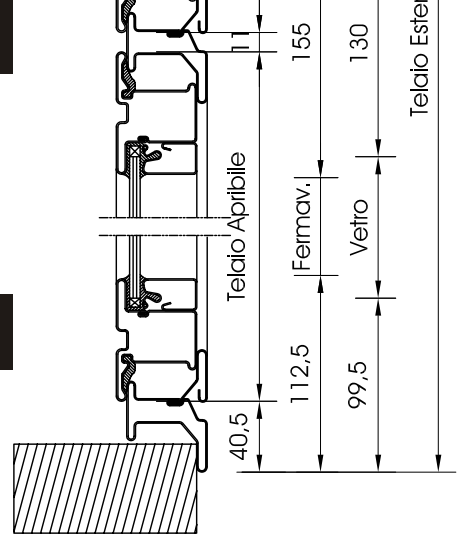

6

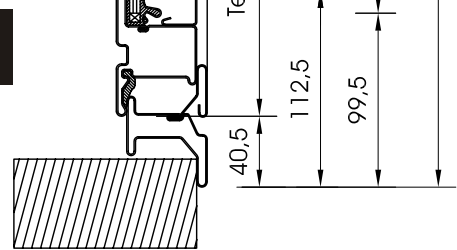

3

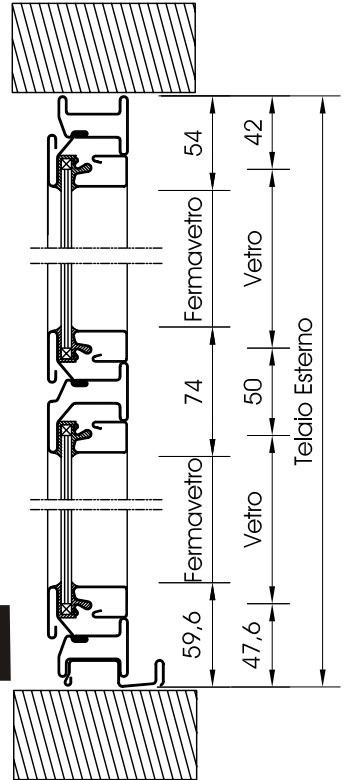

9

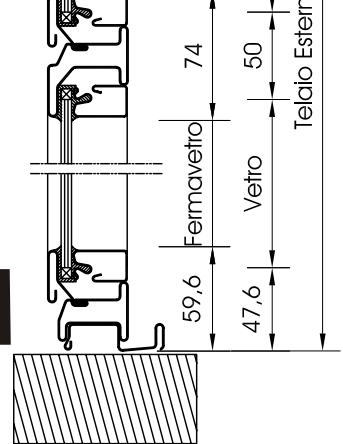

3bis

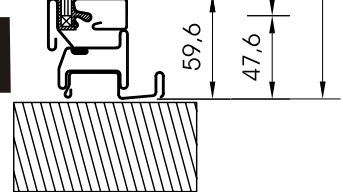

SEZIONI ORIZZONTALI

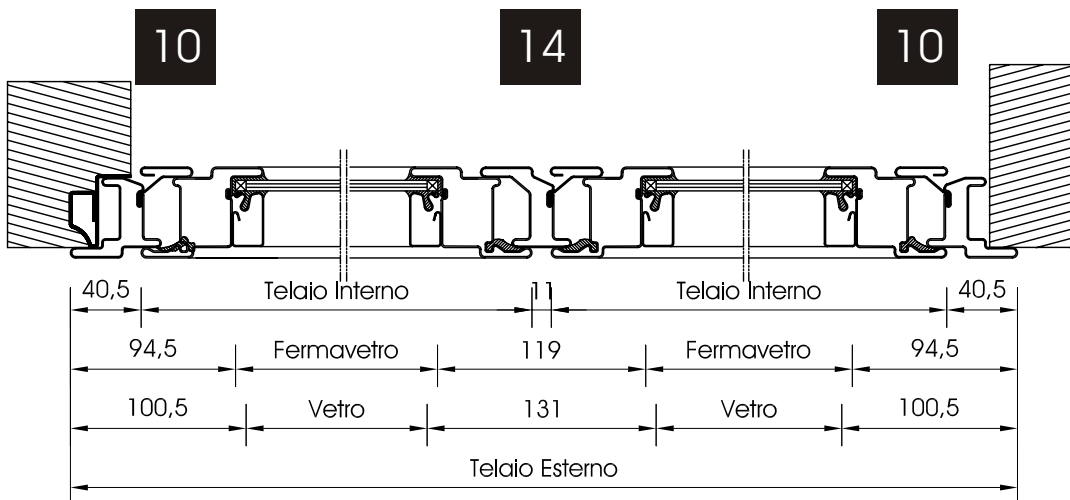
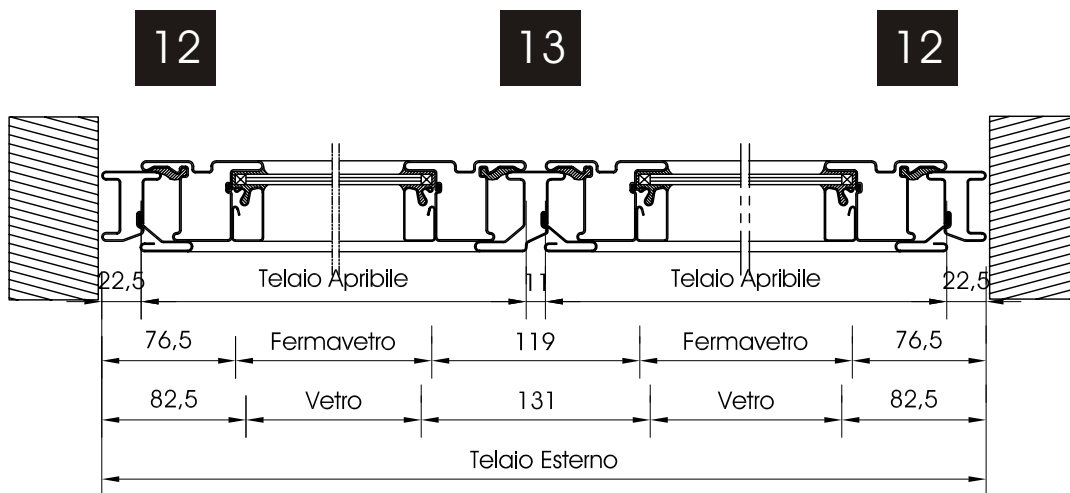
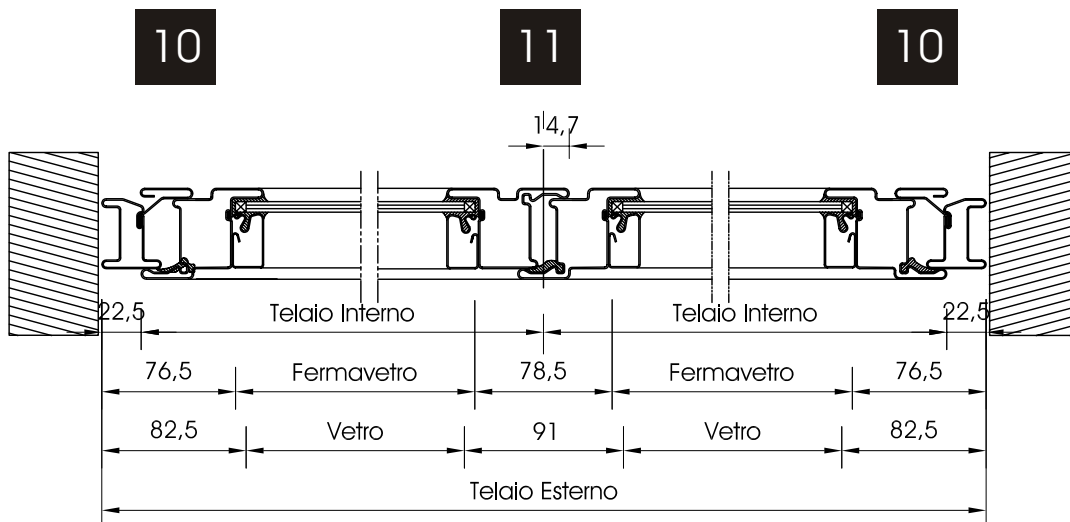

SPEEDY
SECCO

SEZIONI ORIZZONTALI

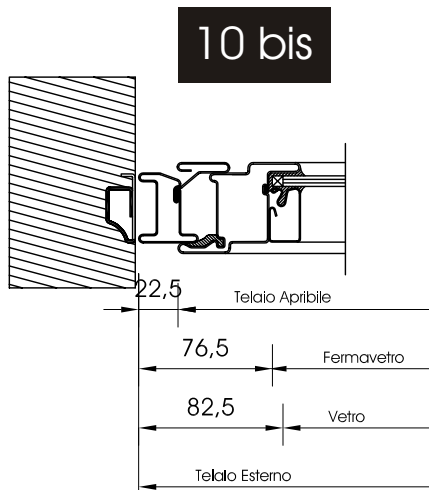
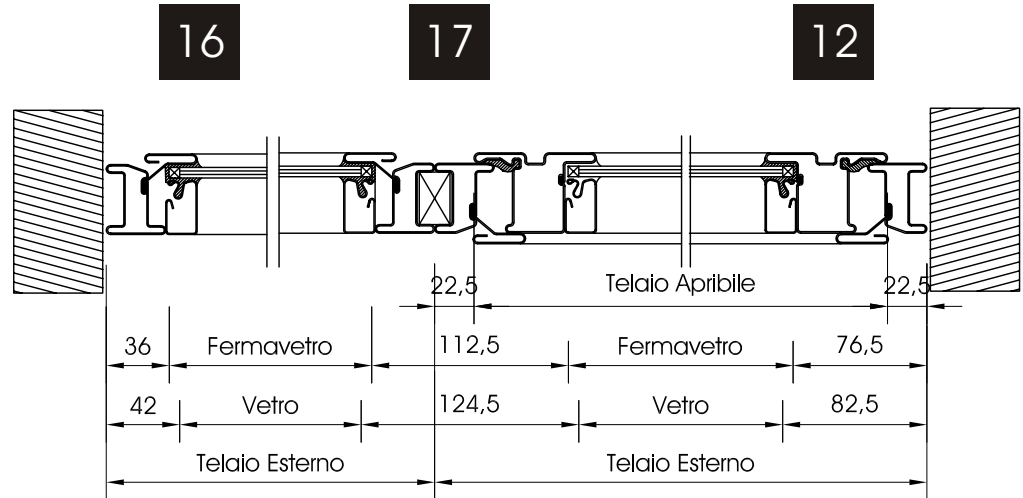
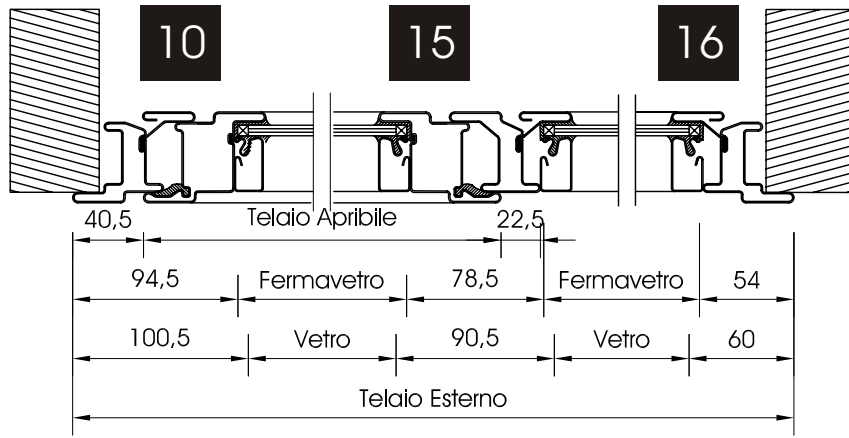

SPEEDY

SECCO

ATREZZATURE PER LAVORAZIONI

AT 1201

Fori per squadrette di
assieme di fianchi e basi
(P4527, P4528 e P4544).

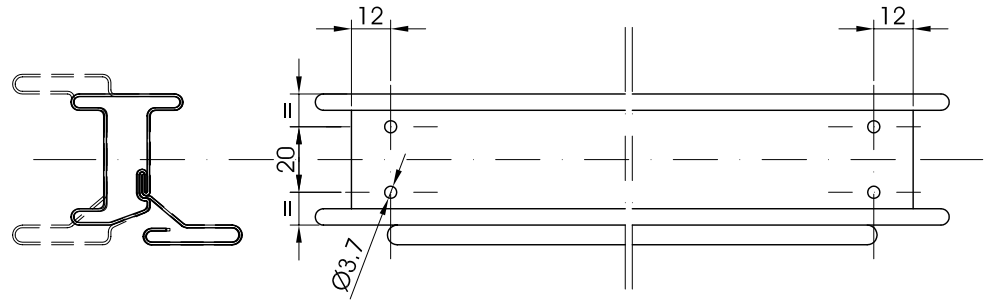

AT 1201

Fori per squadrette e feritoie
per uscita asta su basi (P4170
e P4171).

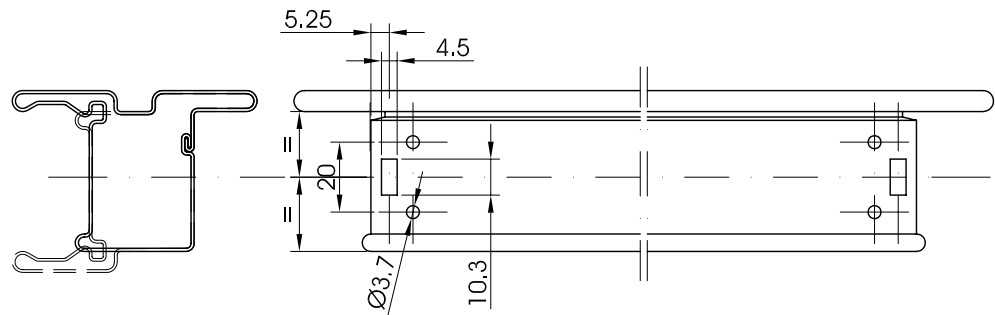

AT 1201

Tranciatura asta AC4390 a
dimensione e feritoie per
aggancio su cremonese.

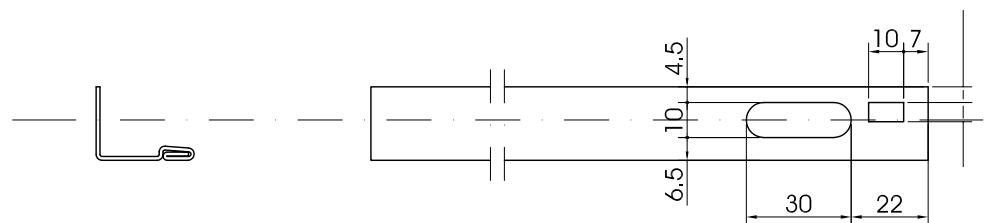

SPEEDY

SECCO

ATREZZATURE PER LAVORAZIONI

AT 1201

Feritoie e fori per fissaggio cremonese su fianco destro (P4170 e P4171).

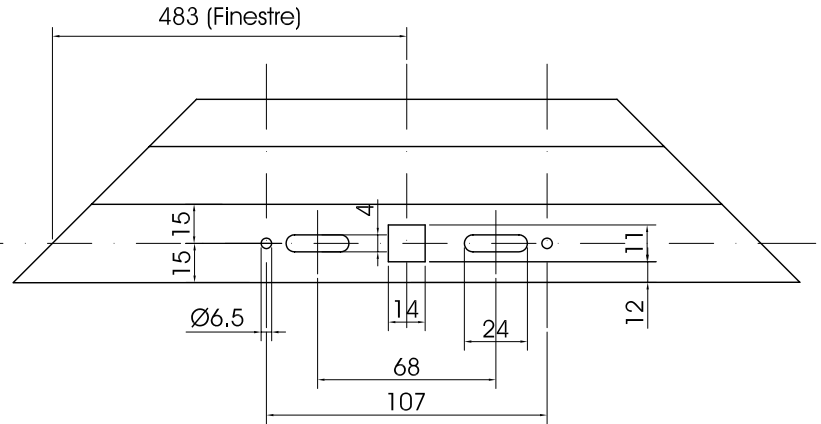
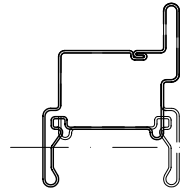

SPEEDY

SECCO

AT 1202

Feritoie scarico acqua base inferiore.
Per P4527, P4528 e P4544 aperture interne.

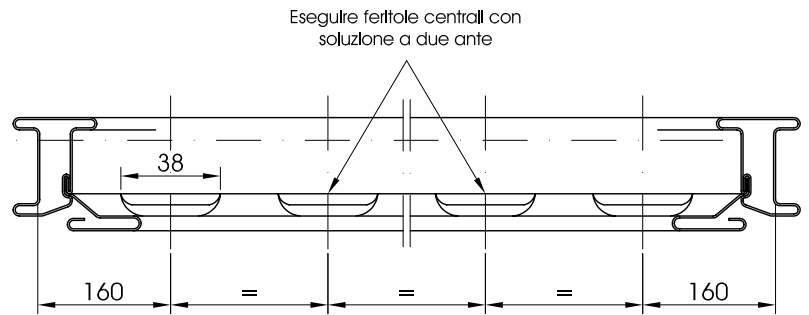
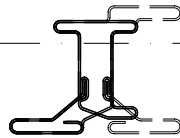

AT 1202

Feritoie e fori per scarico acqua base inferiore.
Per P4527, 4528, 4544 aperture esterne per AC4386.

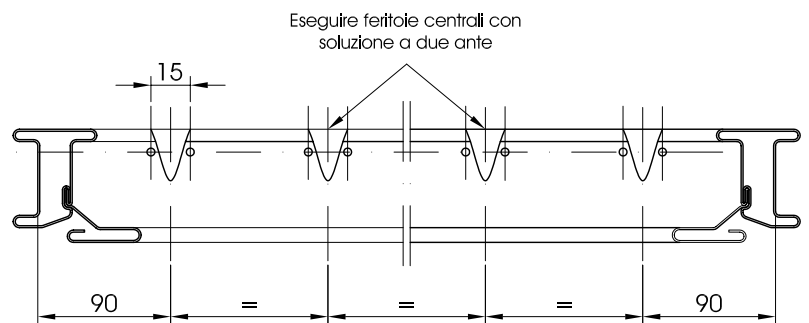
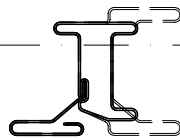

LAVORAZIONI FORI FISSAGGIO AC4452 RONDELLA PER FERMAVETRO A SCATTO SU FIANCHI E BASI

N.B.: LAVORAZIONE EFFETTUABILE CON MASCHERA AT1603

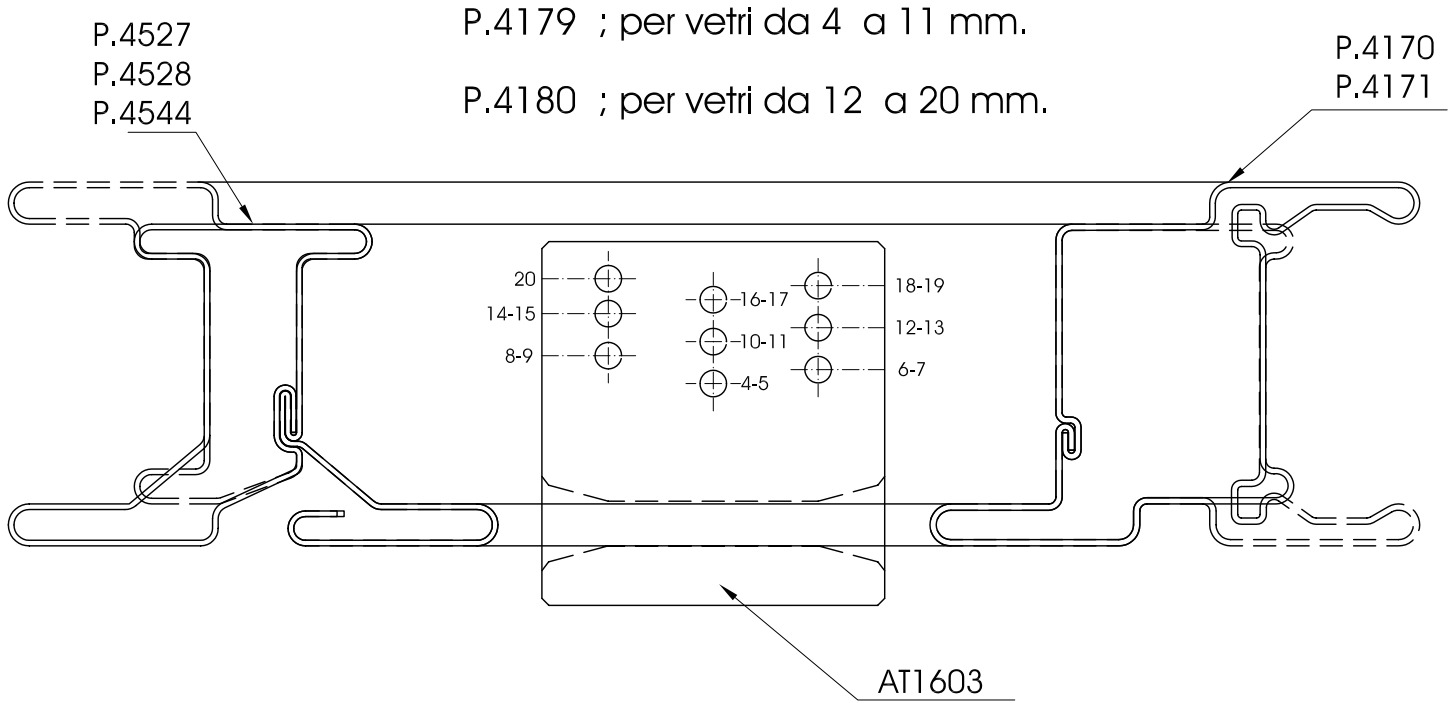

LAVORAZIONI FISSAGGIO CERNIERA AC4350 - AC4350S

N.B.: LAVORAZIONE EFFETTUABILE CON AT1211

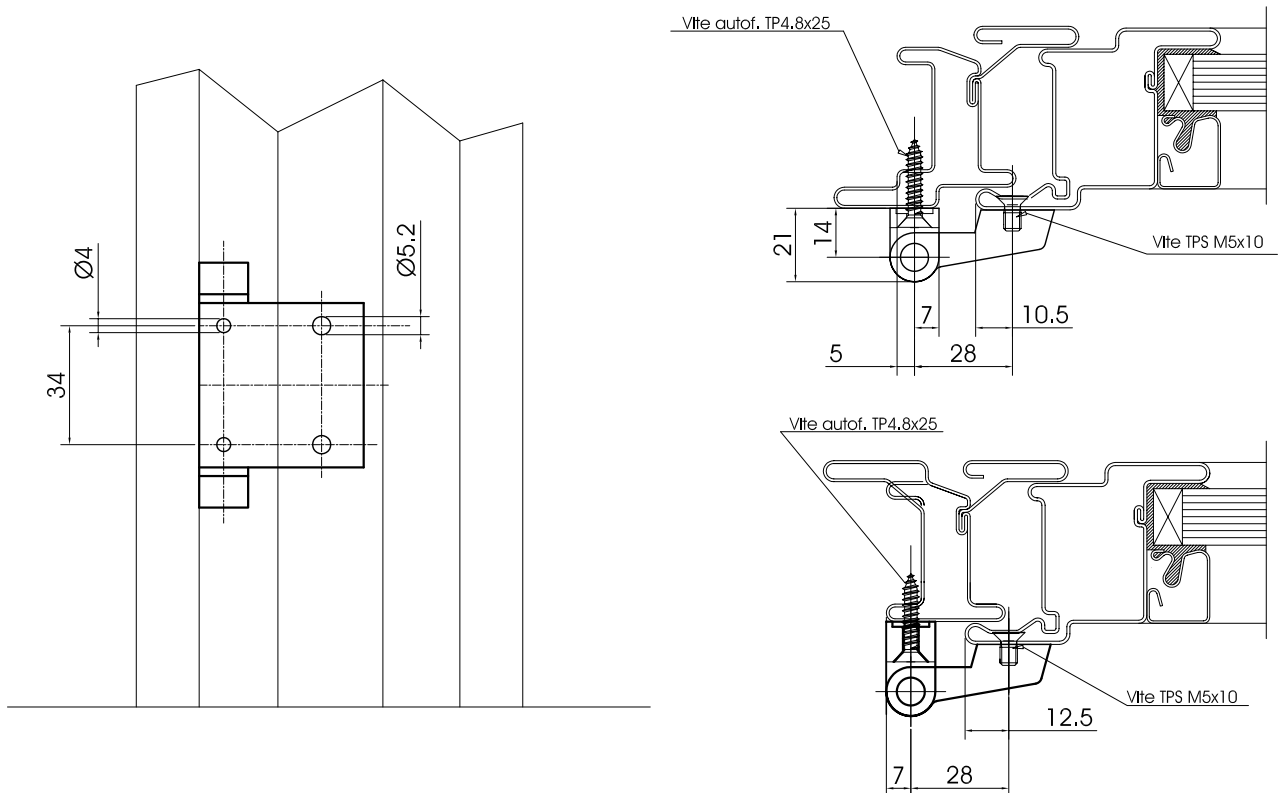

SECCO SPEEDY

LAVORAZIONI TAGLIO PUNTE PER FISSAGGIO FIORETTI AC4271/4298

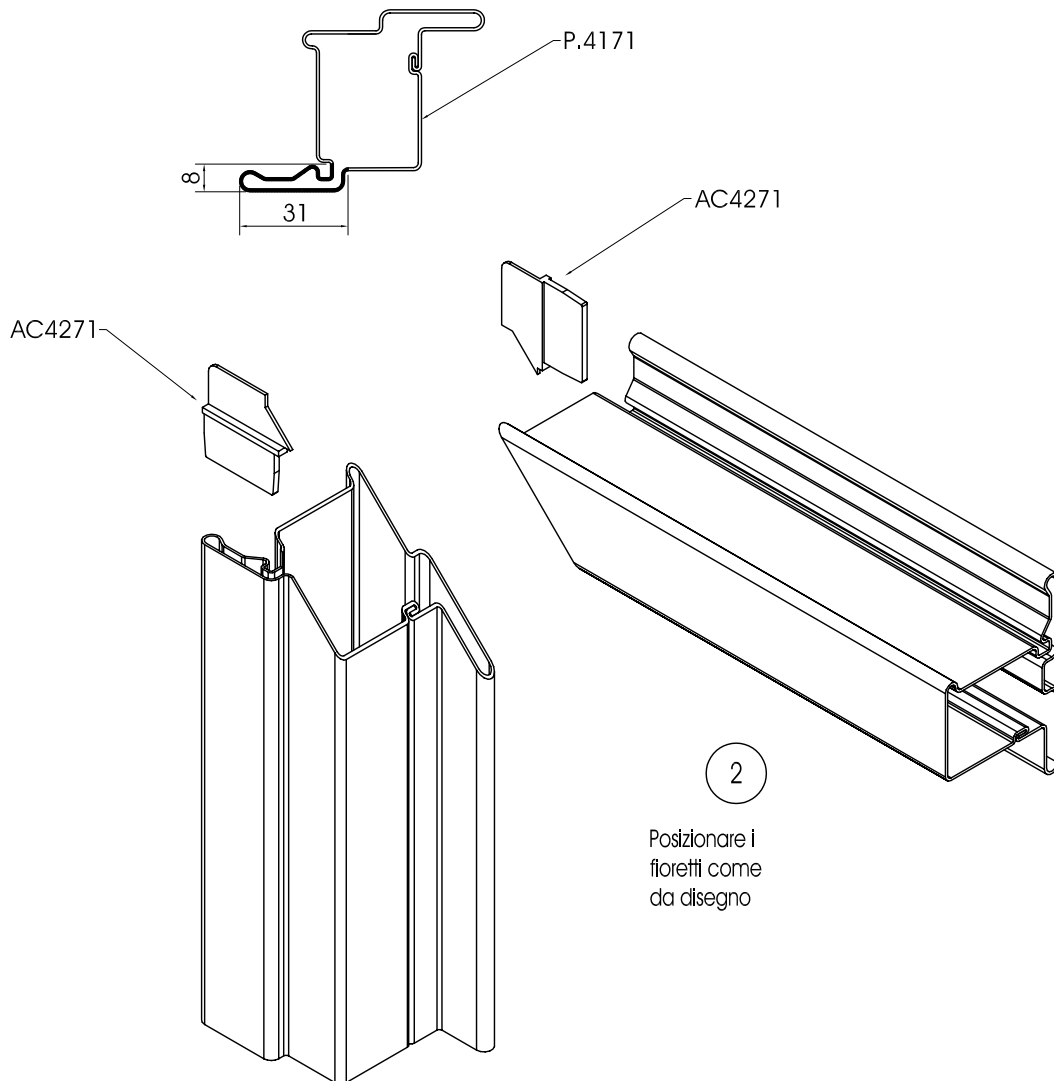
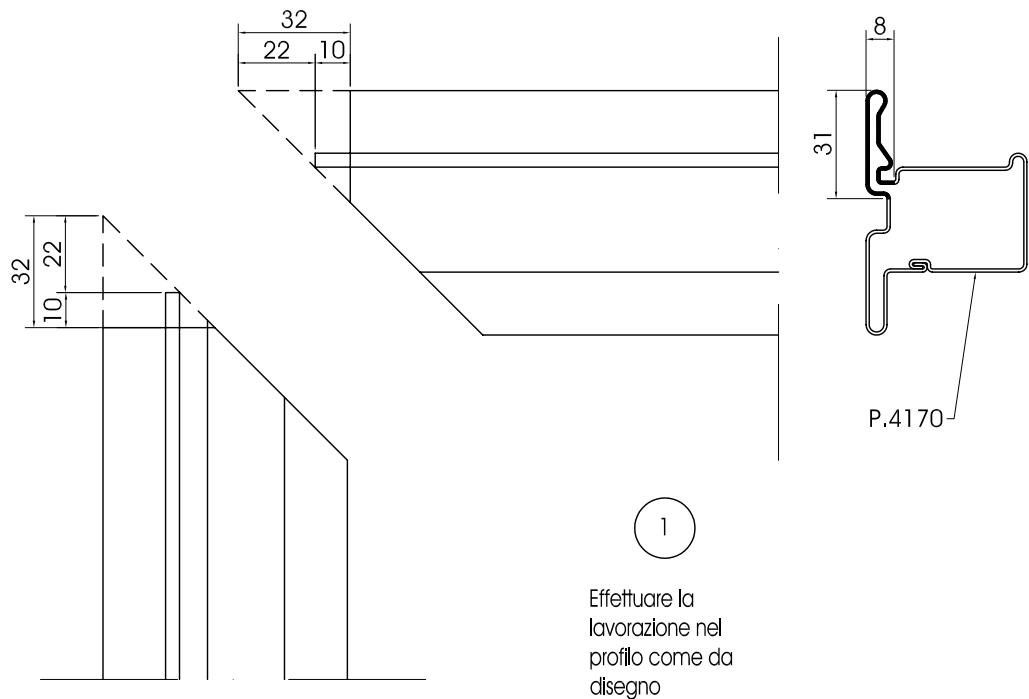

N.B.: Utilizzare AC4298 su angolo inferiore

SPEEDY

SECCO

LAVORAZIONI FISSAGGIO CATENACCIO AC4326

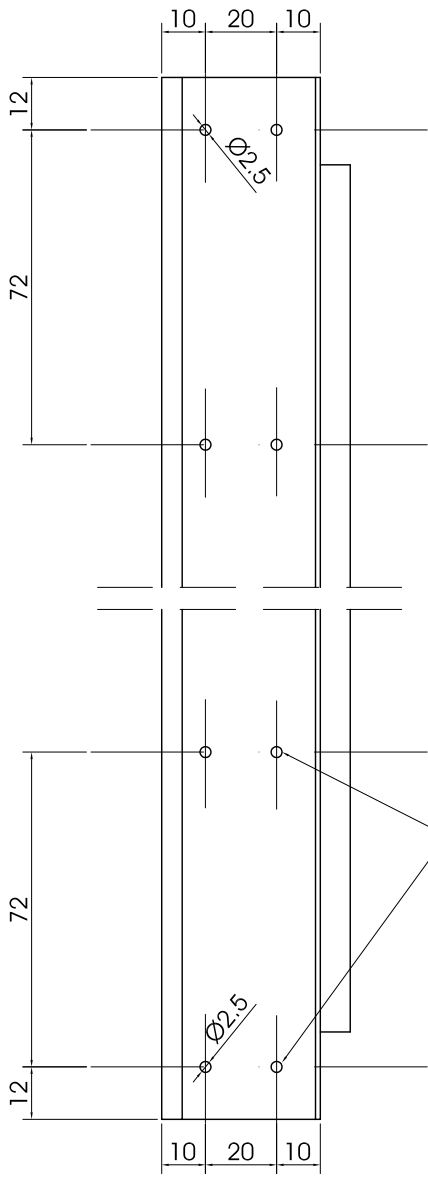

n° 8 viti TPS 3.5x15.9

P.4171
P.4170

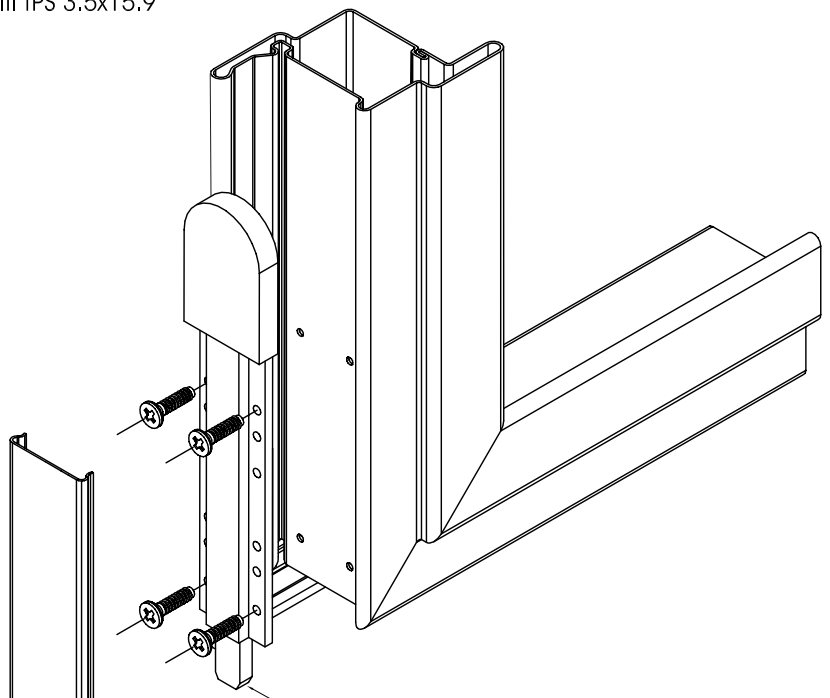
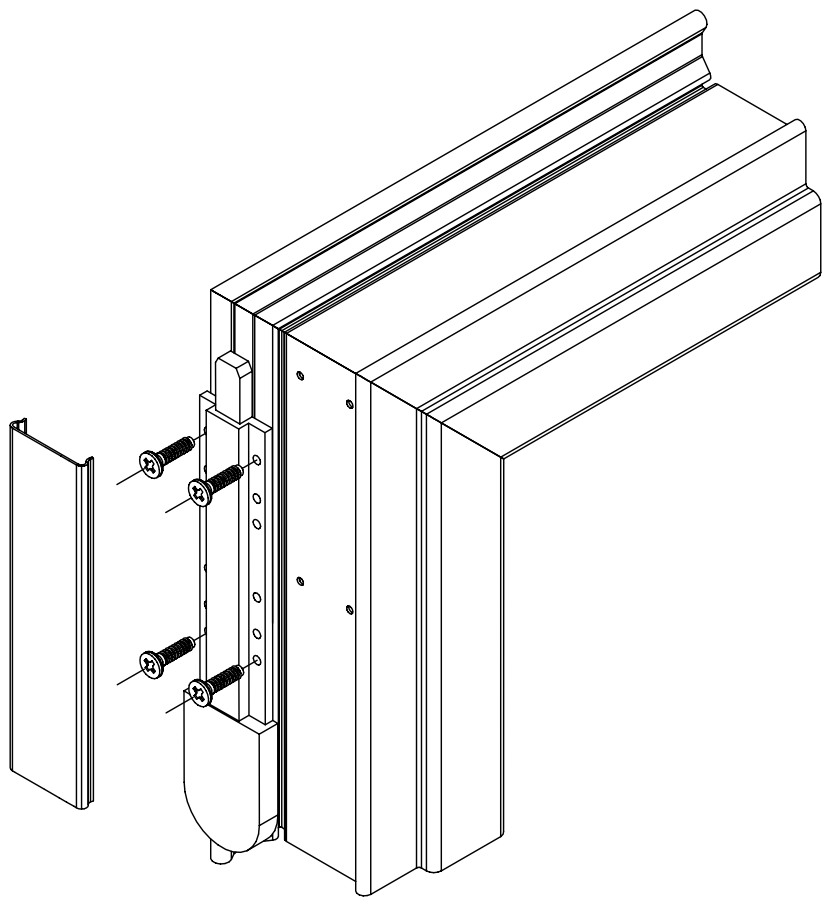
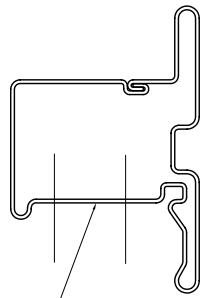

AC4226

Copertina

SECCO
SPEEDY

LAVORAZIONI FISSAGGIO CRICCHETTO AC4040

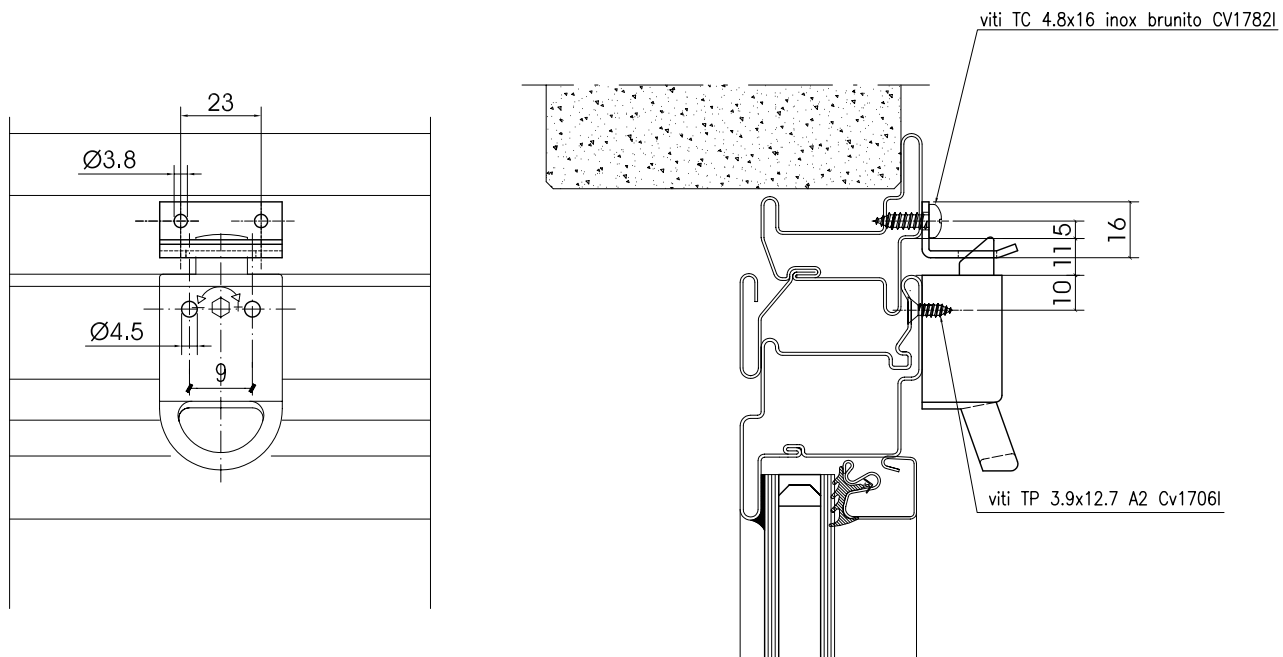

LAVORAZIONI FISSAGGIO CRICCHETTO AC4040S

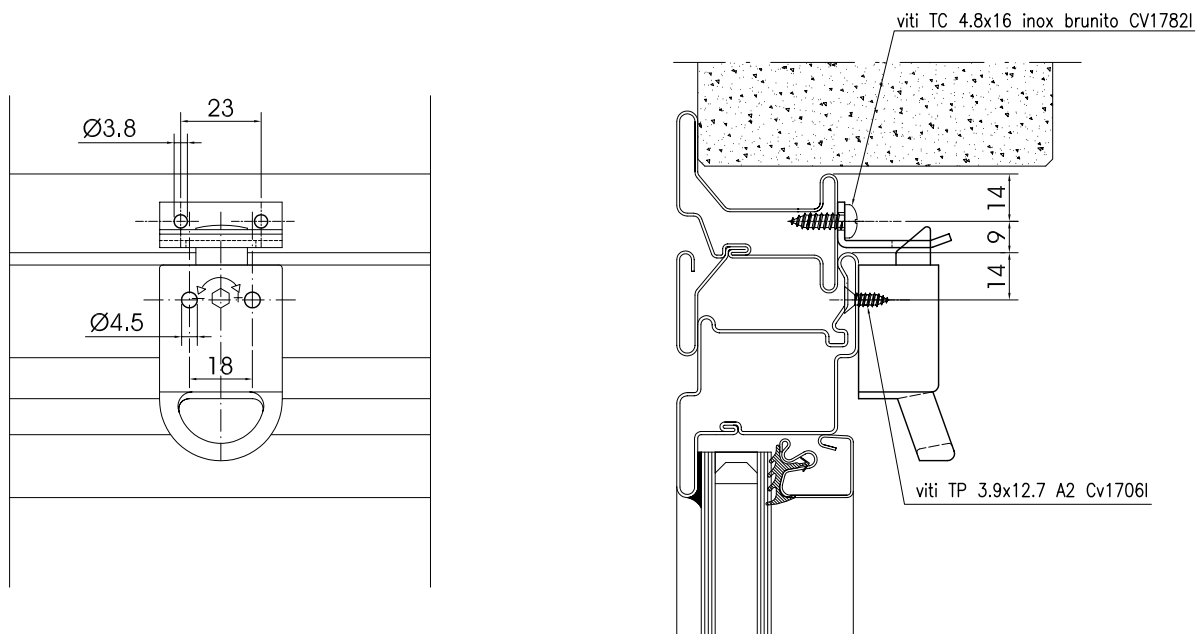

SPEEDY

SECCO

LAVORAZIONI FORO INCONTRO ASTE CREMONESE
AC4265 AC4345/4346

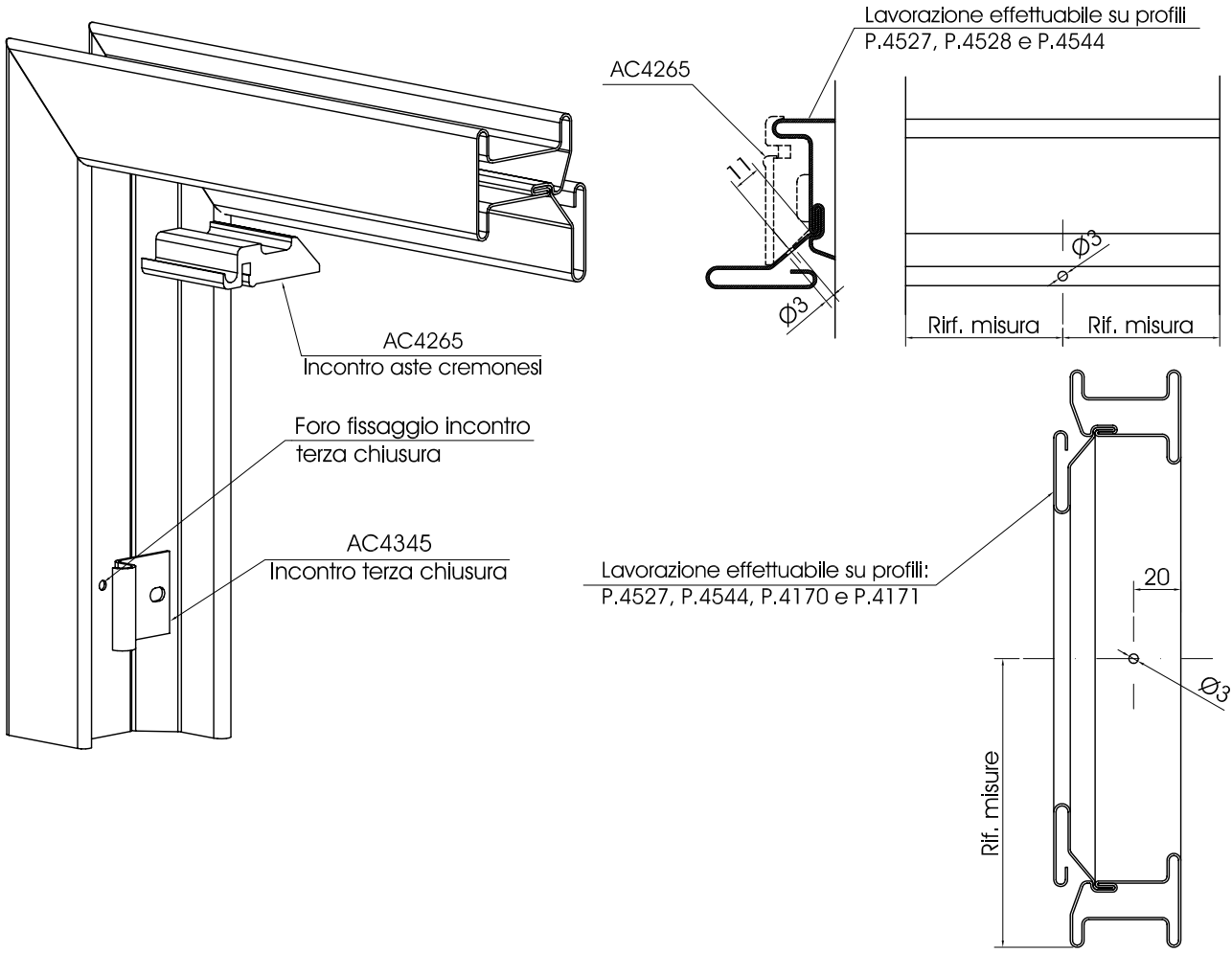

FORI FISSAGGIO APPLICAZIONE MANIGLIA
A TAVELLINO AC4037

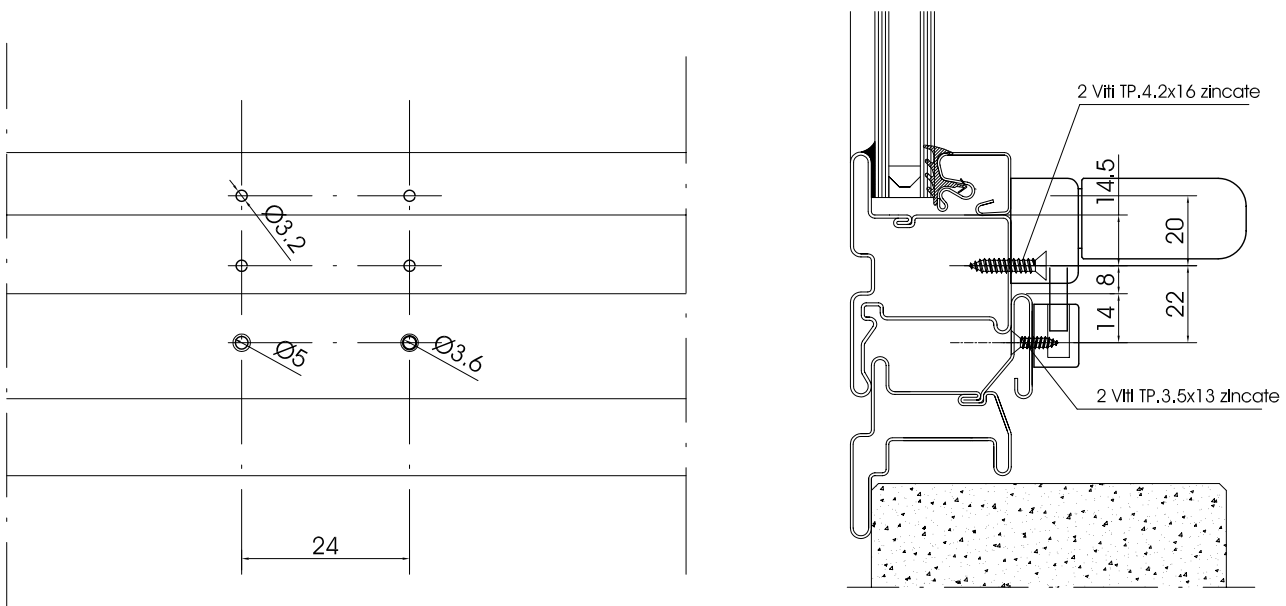

SECCO SPEEDY

LAVORAZIONI FORO FONDINO AC4373 ED AC4374
SU TRAVERSO INTERMEDIO

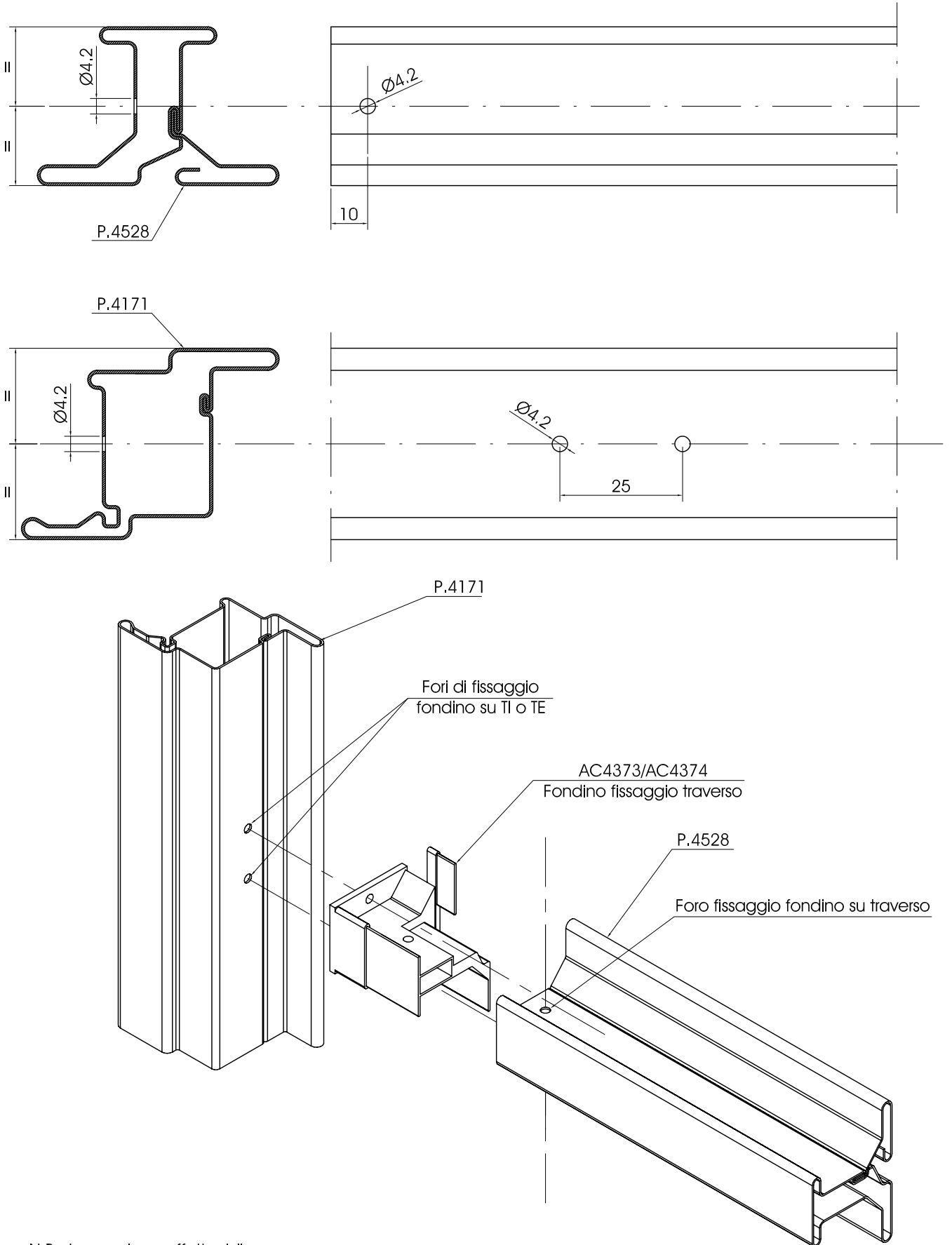

N.B.: Lavorazione effettuabile anche su AC4259 e AC4260

SPEEDY

SECCO

LAVORAZIONI FORI VASCHETTA RACCOGLI CONDENSA P.4529

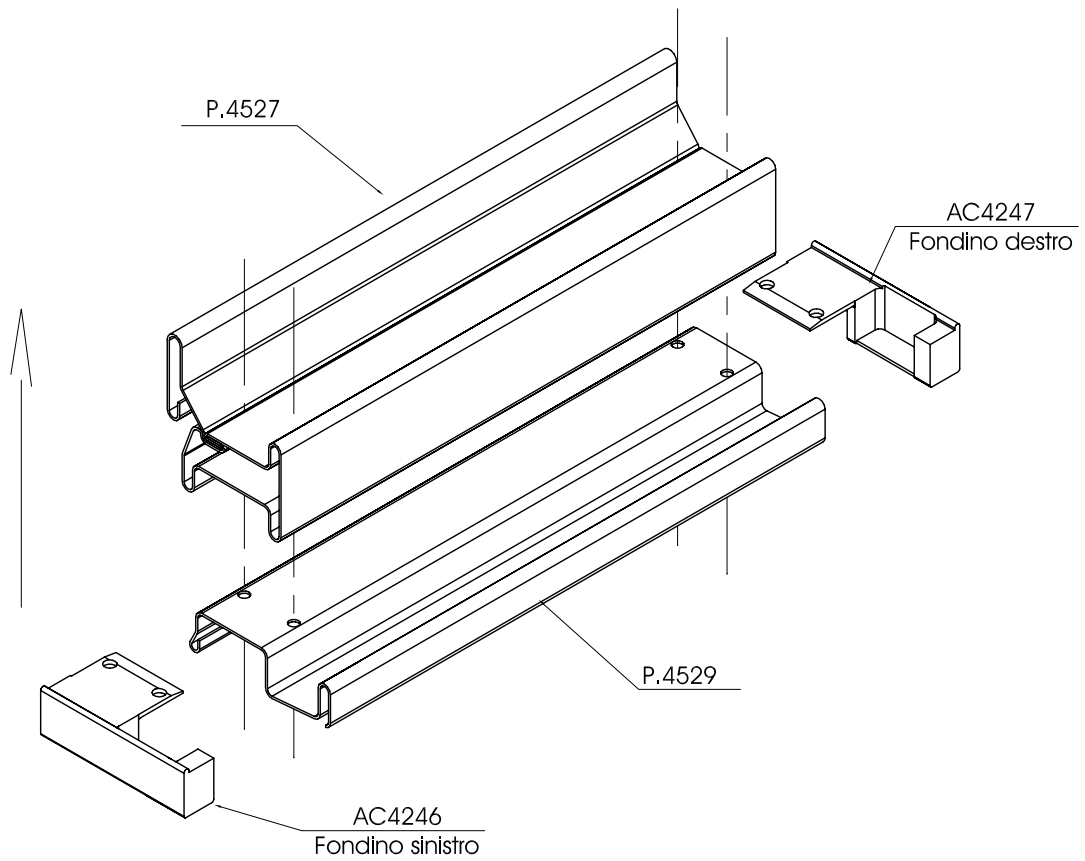
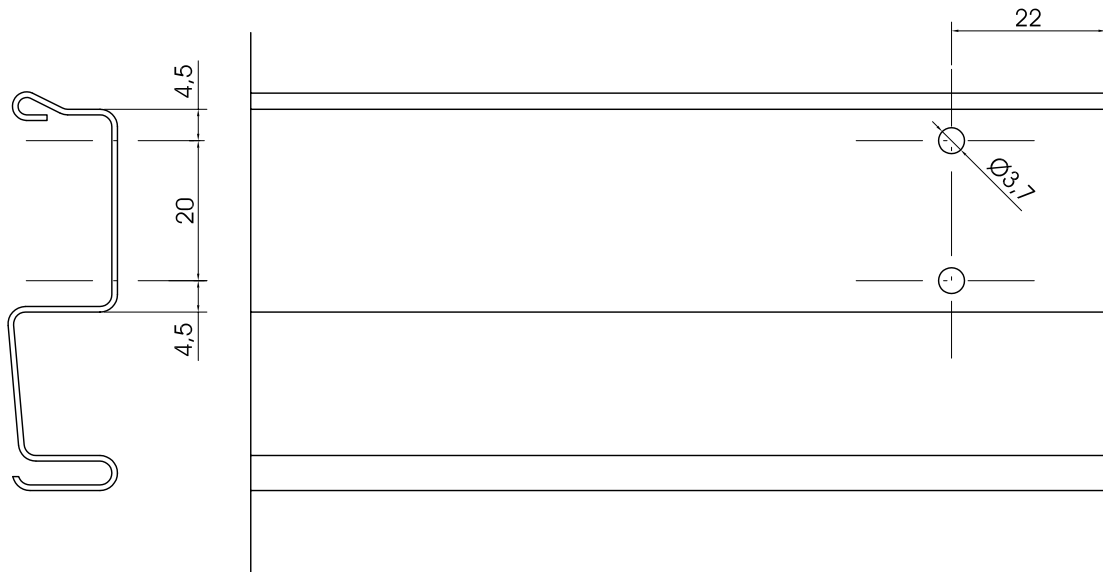

SPEEDY

SECCO

P.2001

A cm ²	3.22
P kg/m	2.53
Jx cm ⁴	14.00
Jy cm ⁴	17.40
Wx cm ³	4.50
Wy cm ³	4.00

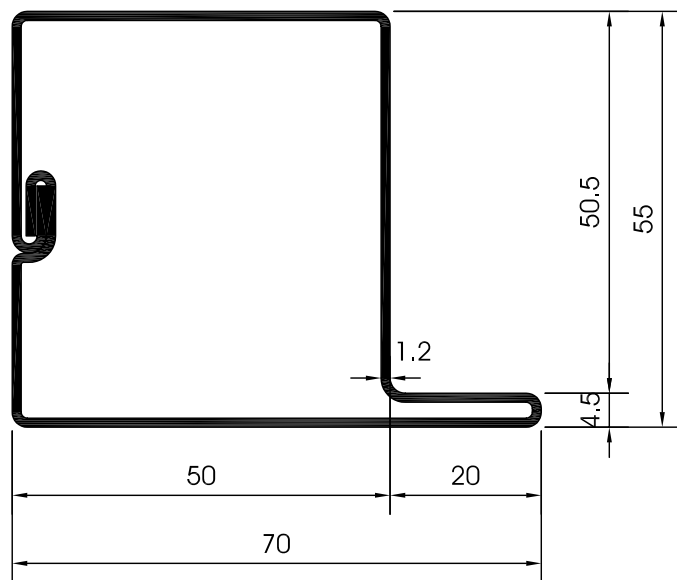

P.2002

A cm ²	3.84
P kg/m	2.88
Jx cm ⁴	15.94
Jy cm ⁴	23.70
Wx cm ³	4.74
Wy cm ³	4.98

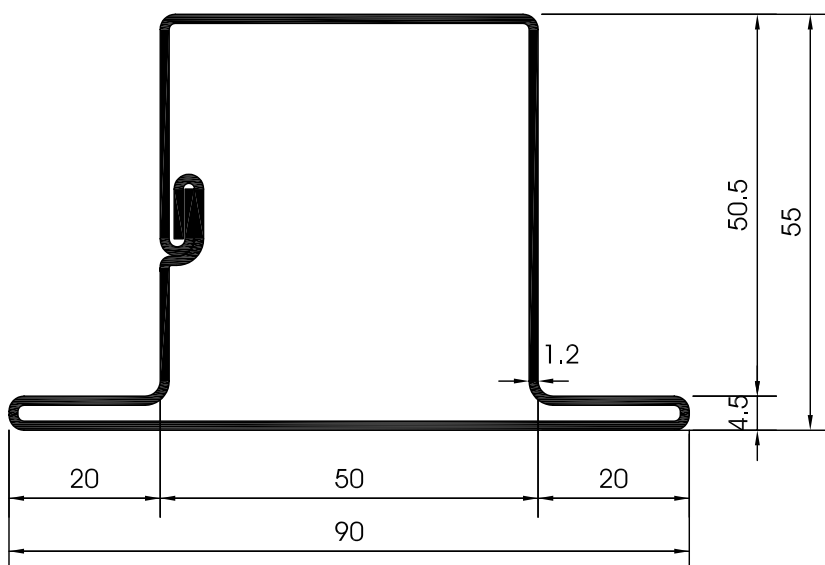

P.2003

A cm ²	3.84
P kg/m	2.84
Jx cm ⁴	17.40
Jy cm ⁴	23.70
Wx cm ³	6.33
Wy cm ³	4.98

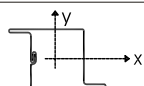
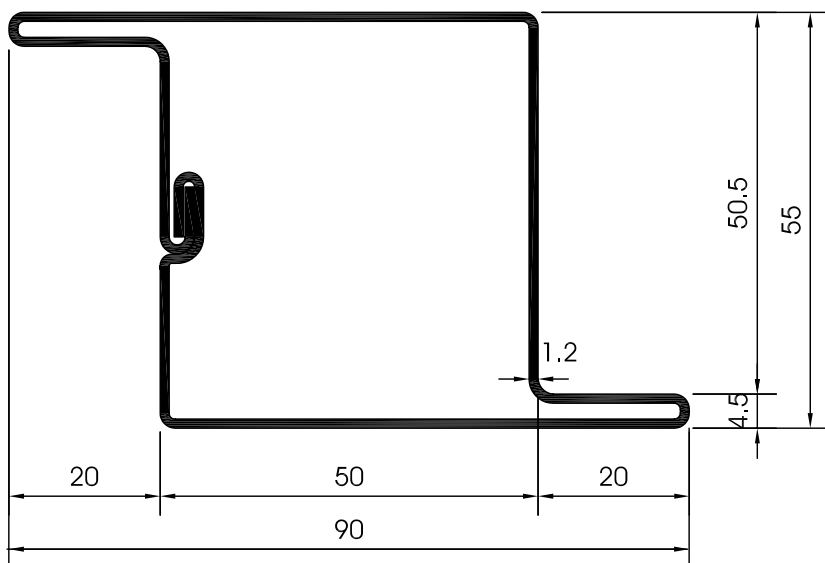

A = area della sezione
 P = massa teorica
 Jx = momento d'inerzia baricentrico, asse x
 Jy = momento d'inerzia baricentrico, asse y

Wx = momento resistente baricentrico, asse x
 Wy = momento resistente baricentrico, asse y

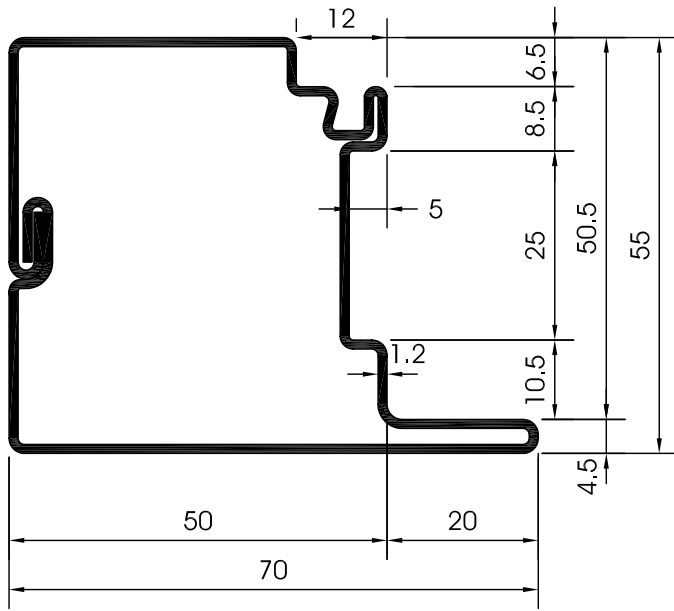

P.2011	
A cm ²	3.39
P kg/m	2.64
Jx cm ⁴	14.00
Jy cm ⁴	17.70
Wx cm ³	4.60
Wy cm ³	4.16

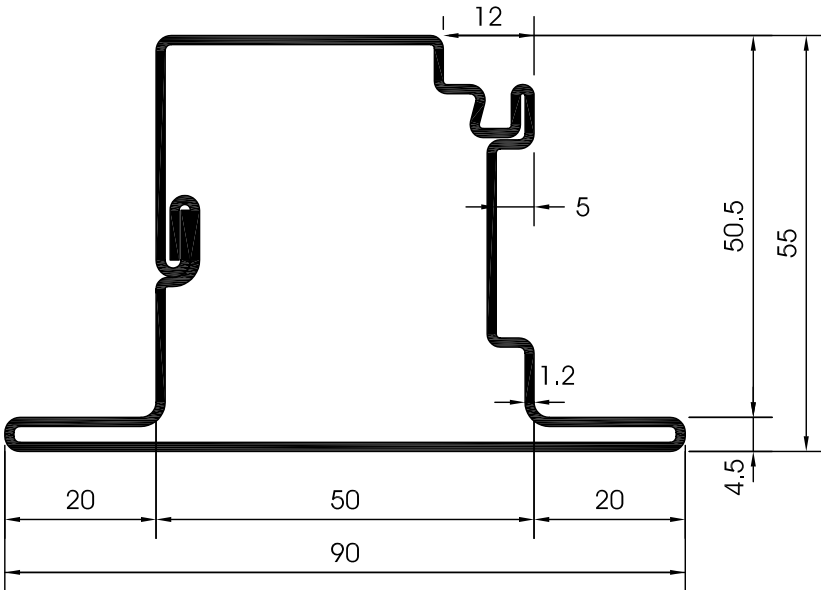

P.2012	
A cm ²	3.84
P kg/m	2.99
Jx cm ⁴	16.12
Jy cm ⁴	24.00
Wx cm ³	4.88
Wy cm ³	5.12

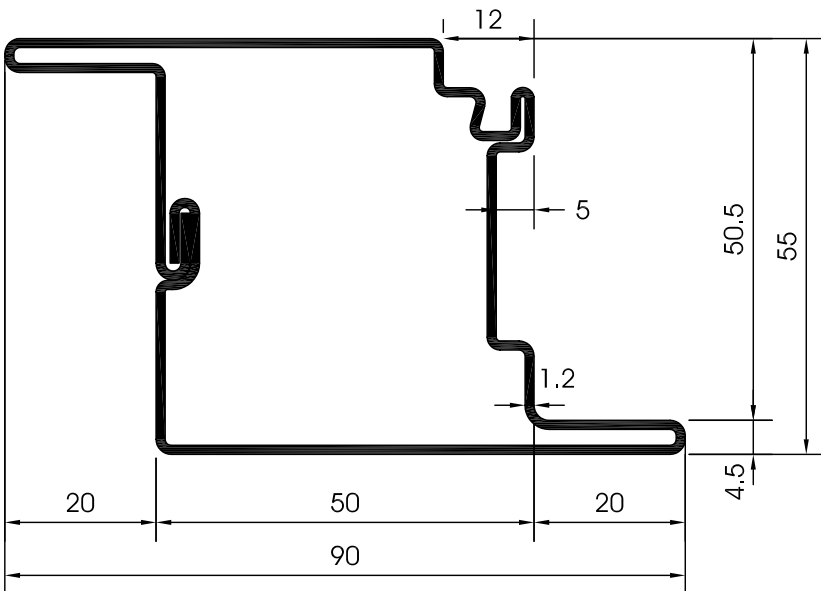

P.2013	
A cm ²	3.84
P kg/m	2.96
Jx cm ⁴	17.38
Jy cm ⁴	24.00
Wx cm ³	6.27
Wy cm ³	5.13

SECCO SPEEDY

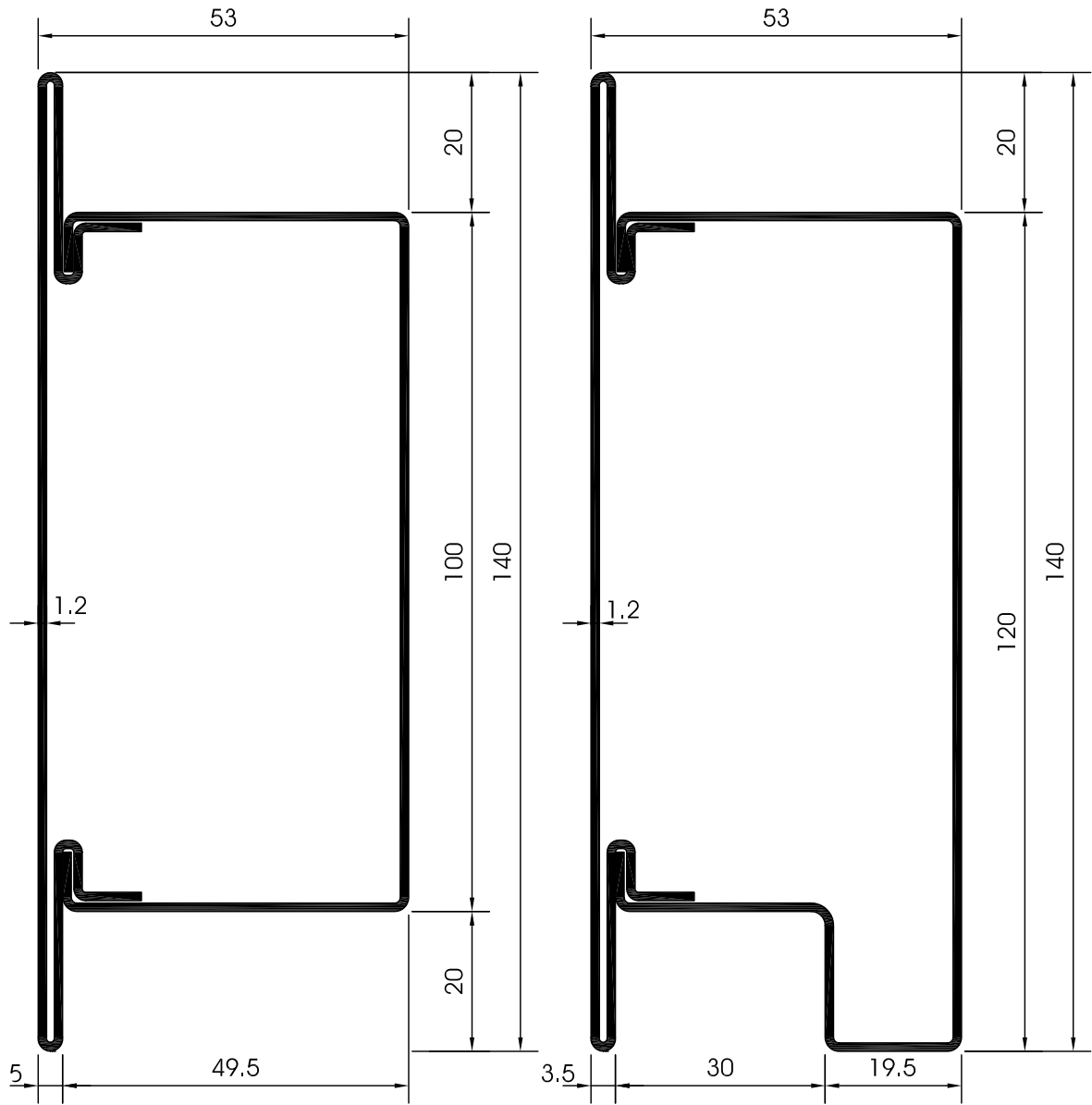

P.2004	
A cm ²	4.88
P kg/m	4.30
Jx cm ⁴	106.60
Jy cm ⁴	24.60
Wx cm ³	14.90
Wy cm ³	7.50

P.2005	
A cm ²	5.30
P kg/m	4.66
Jx cm ⁴	126.35
Jy cm ⁴	27.56
Wx cm ³	16.89
Wy cm ³	5.80

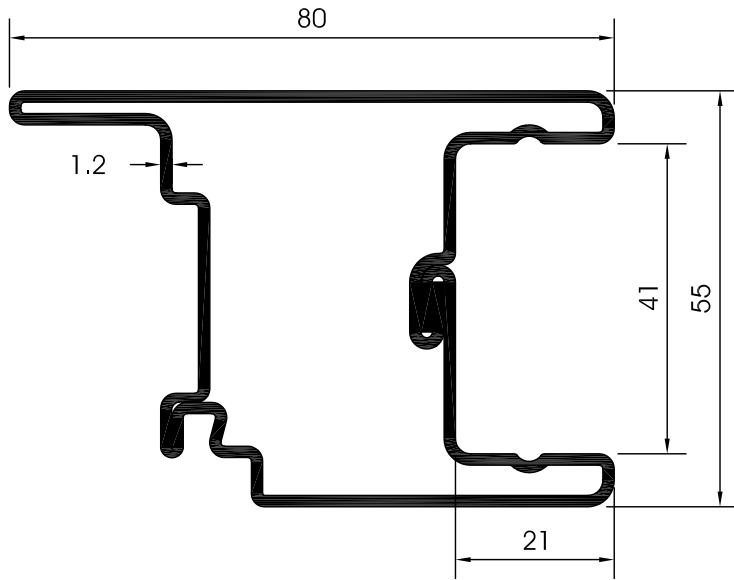

P.2201	
A cm ²	5.20
P kg/m	3.88
Jx cm ⁴	8.44
Jy cm ⁴	1.46
Wx cm ³	1.77
Wy cm ³	2.84

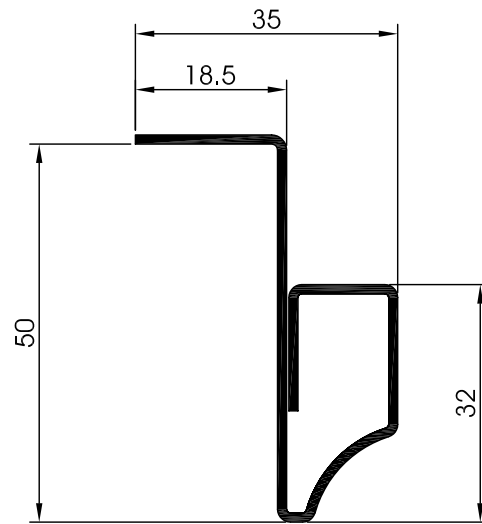
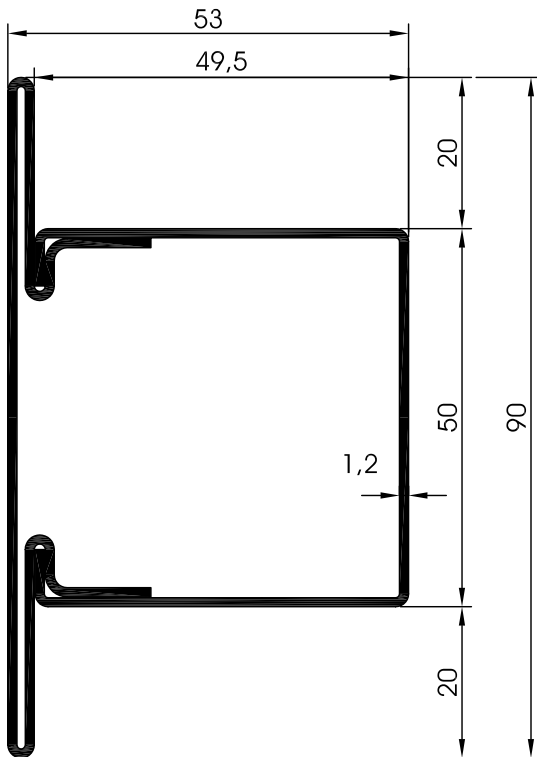

P.2014	
P kg/m	3.35
TRAVERSO 'T' IN DUE ELEMENTI, PER ASSIEMAGGIO MECCANICO	

P.0905	
P kg/m	1.54
PROFILO FALSOTELAIO	

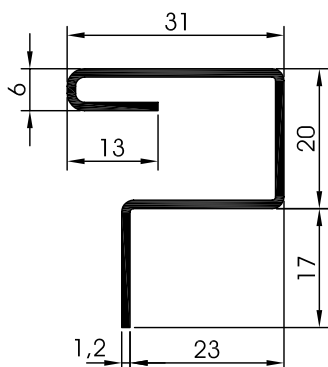

P.2218	
P kg/m	0.96
PROFILO SOTTOZOCICOLO	





SPEEDY

SECCO

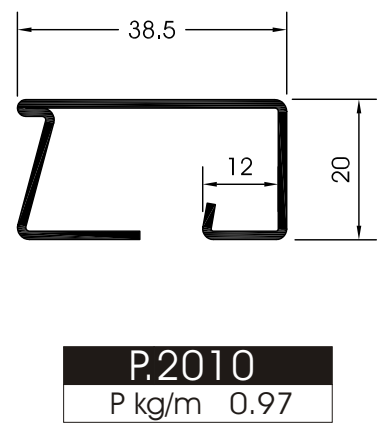
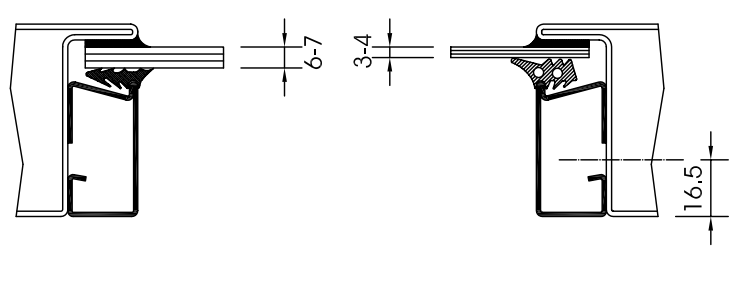
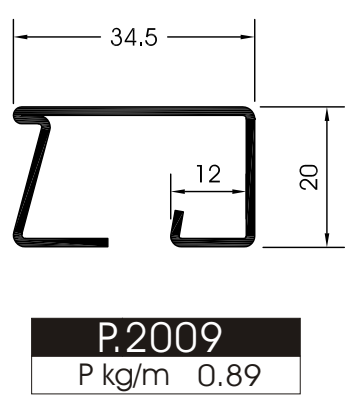
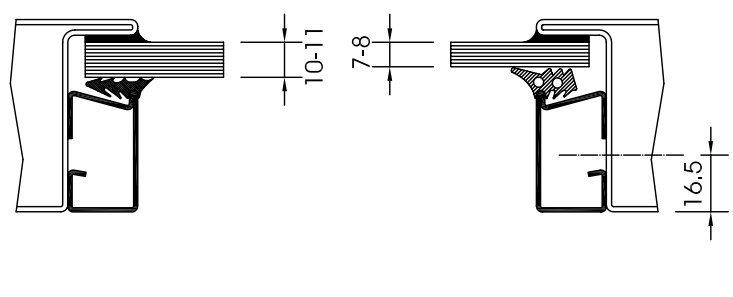
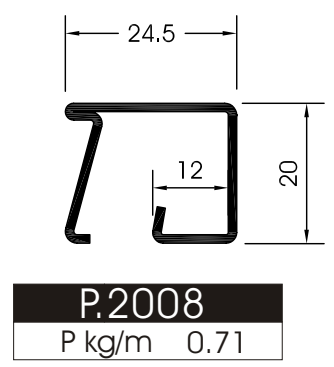
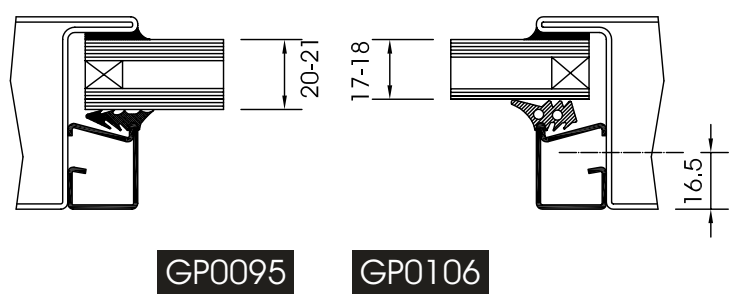
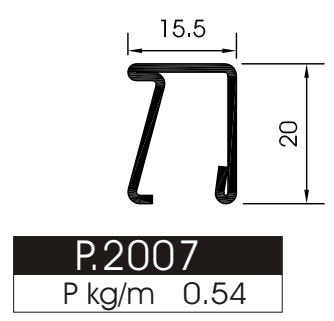
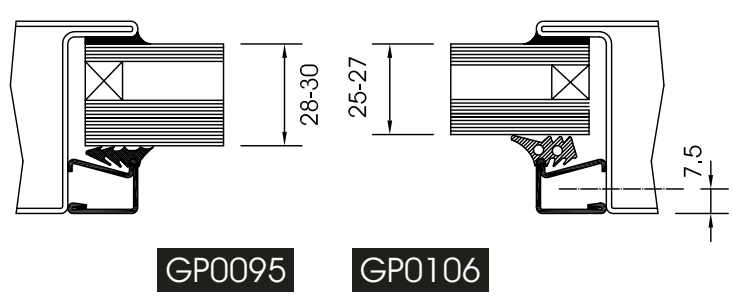



AC 0626

Tappo chiusura fori
fissaggio tamponi
per foro Ø10.

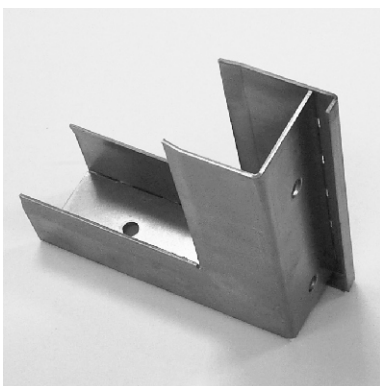

AC 2210

Squadretta per
P2201 in acciaio
zincato. (Completo di viti
TSPEI M6x18 e rivetti M6)



AC 5002

Coppia di maniglie
in acciaio inox.
(Completo di n°4 viti
TPS 3.9x19)



AC 5005

Serratura multipunto
scrocco con
catenaccio. (Completo
di viti TPS 4.2x25)

AC 5006

Serratura multipunto
rullo con
catenaccio.
(Completo di viti TPS 4.2x25)

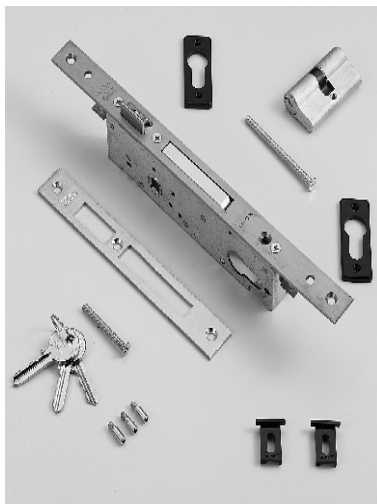

AC 5007

Serratura normale scrocco
con catenaccio. (Completo
di viti TPS 4.2x25)

AC 5008

Serratura normale rullo con
catenaccio. (Completo di viti
TPS 4.2x25)

AC 5009

Elettroserratura
normale. (Completo di viti
TPS 4.2x25)



AC 5010

Coppia aste verticali
per serratura
normale.



AC 5011

Catenaccio in lega.
(Completo di n°5 viti
TPS 3.9x19)



AC 5029..

Cerniera a 2 ali da
avvitare dx/sx, in
acciaio, per finestre.
(Completo di n° 6 viti
TC 4.2x12.7 inox).

AC5029 : zincato
AC5029V : verniciato

SPEEDY

SECCO



AC 5030

Coppia limitatori di apertura vasistas in acciaio. (Completi di n° 8 viti TC 4.2x9.5 inox).

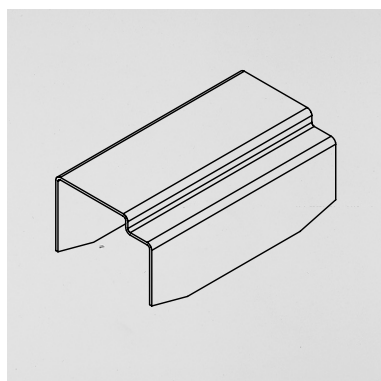

AC 5034

Inserto per cerniera (AC5029) su T.E. In acciaio zincato.

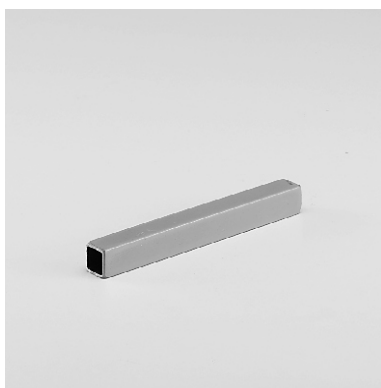

AC 5035I

Inserto per cerniera (AC5029) su T.I. In acciaio inox. (Completo di viti di fissaggio TC 4.2x12.7)



AC 5040

Cricchetto da avvitare in lega e nylon nero con incontro in acciaio INOX. (Completo di 2 viti TCEI 4.8x16; 2 viti TPS 3.9x13).



AC 6001

Squadretta per T.E. sinistra in acciaio zincato. (Completo di 4 viti di fissaggio TSPEI M5x14 inox).

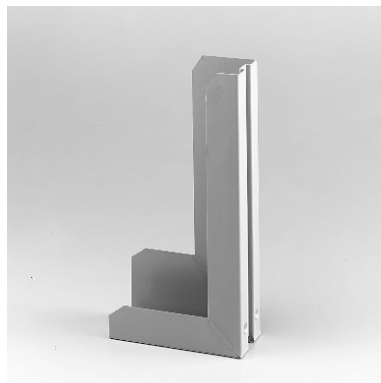

AC 6002

Squadretta per T.E. destra in acciaio zincato. (Completo di 4 viti di fissaggio TSPEI M5x14 inox).

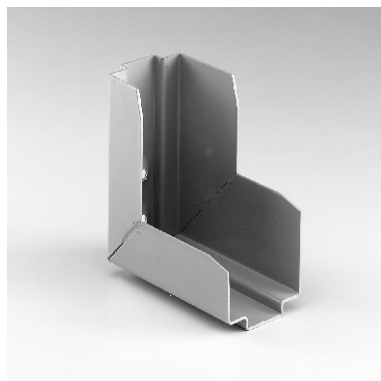

AC 6003

Squadretta per T.I. in acciaio zincato. (Completo di 4 viti di fissaggio TSPEI M6x12 inox).

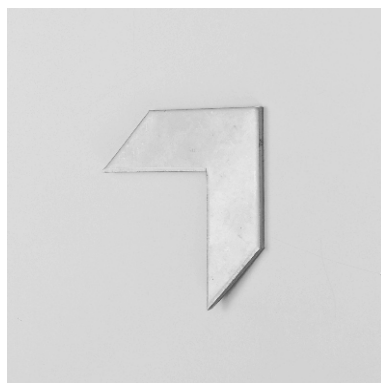

AC 6007

Squadretta di allineamento battuta per T.E. In acciaio zincato.

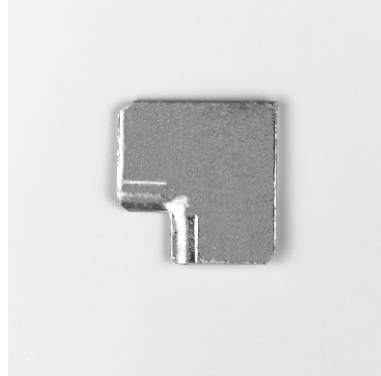

AC 6008

Squadretta di allineamento battuta per T.I. in acciaio zincato.



AC 6009

Cavalotto in acciaio zincato, per profilo fascia P2004. (Completo di 4 viti TCEI M.6x20, n° 2 viti TCTC 4.2x16)

**AC 6010**

Cavalotto in acciaio zincato, per profilo zoccolo P.2005.
(Completo di 2 viti TCEI M.6x20; 4 autt. TCTC 4.2x16)

**AC 6011**

Cavalotto in acciaio zincato, per profilo a T in due elementi P.2014.
(Completo di 2 viti TCEI M 6x20; 4 viti TC 4.2x16)

**AC 6013**

Fioretto destro in plastica, per inversione di battuta.

AC 6014

Fioretto sinistro in plastica, per inversione di battuta.

**AC 6036**

Cerniera a due ali da avvitare registrabile in alluminio ossidato nero.
(Completo di n° 4 viti M.8x28 - n°3 viti TCEI M4x16 e n° 1 grano M6x8)

**CV 5001**

Vite per boccola fermavetri in acciaio zincato TPS 4,2 x16.

CV 5012

Boccola per fermavetri in acciaio zincato o inox.

**GE 2000**

Guarnizione di battuta a palloncino per finestre.

**GE 2001**

Guarnizione di battuta con aletta per porte.

**GP 0095**

Guarnizione interna fermavetro spessore 3 mm.

**GP 0106**

Guarnizione interna fermavetro spessore 6 mm.

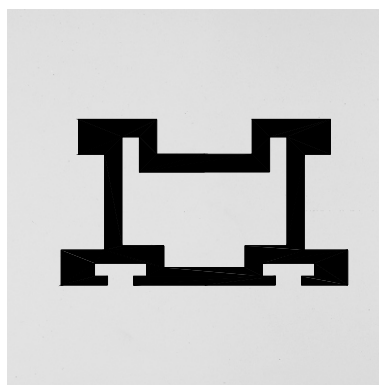
**GU 0120**

Estruso porta spazzolino per porte.

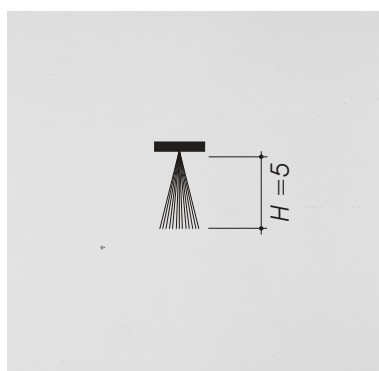
**GU 0087**

Spazzolino per porte, su GU 0120.

SPEEDY

SECCO

LISTA TIPOLOGIE PER PORTE
AD APERTURA INTERNA

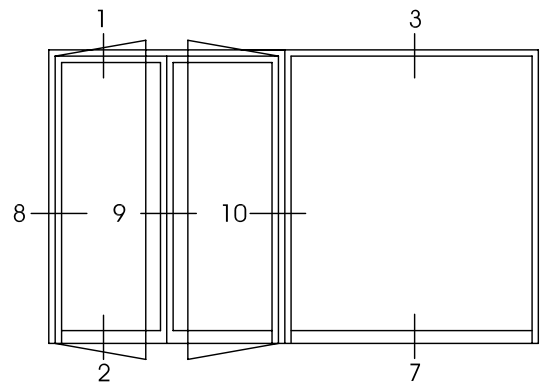
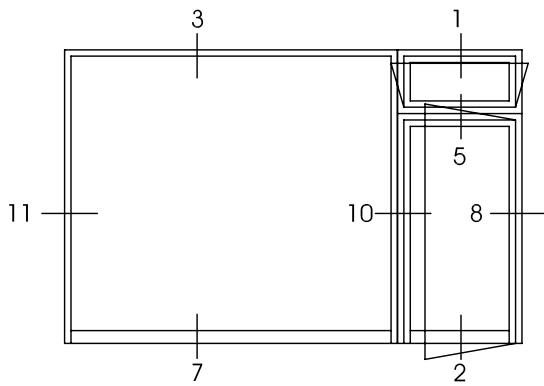
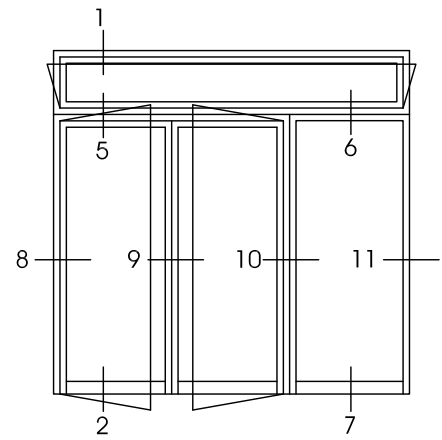
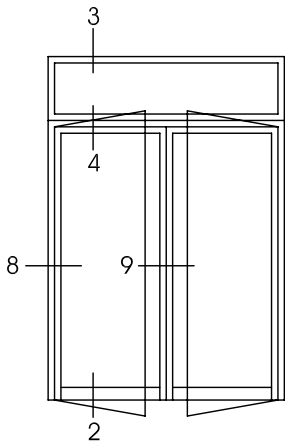
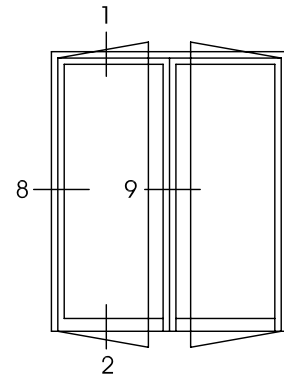
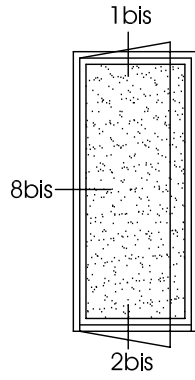
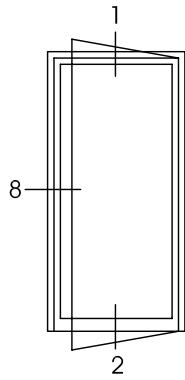

SPEEDY
SECCO

SEZIONI VERTICALI: APERTURA INTERNA

1

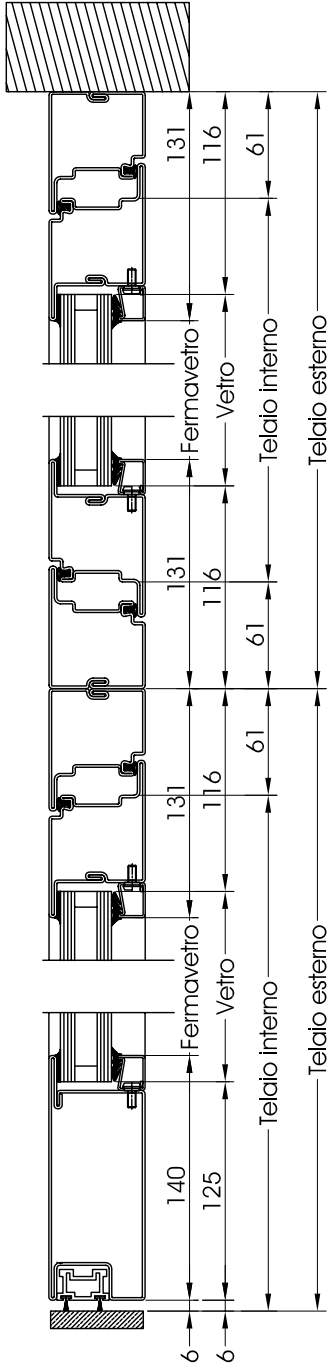

5

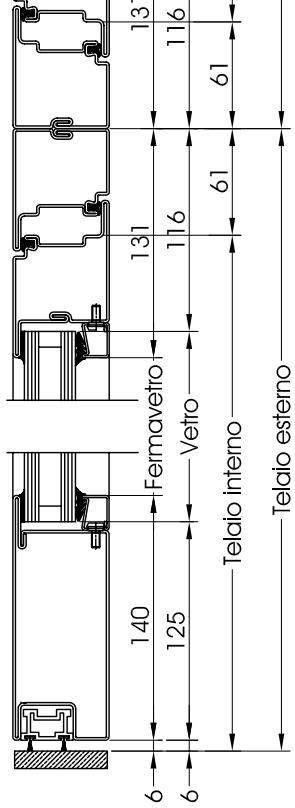

2

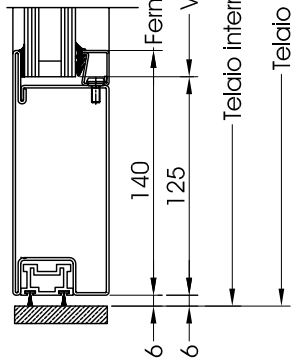

1

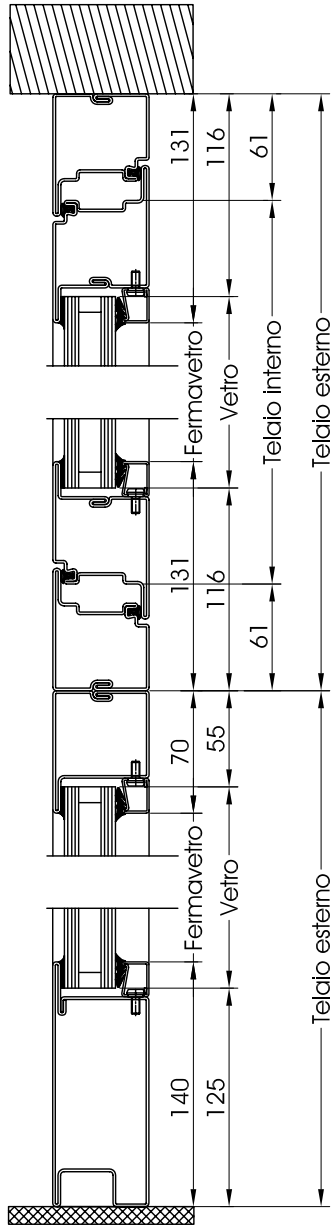

6

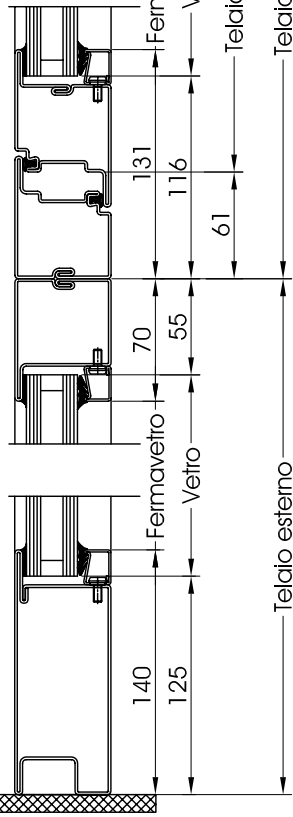

7

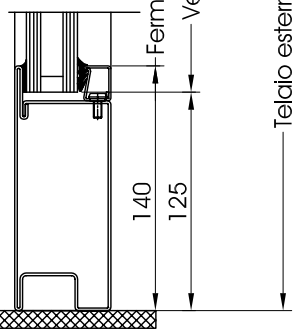

3

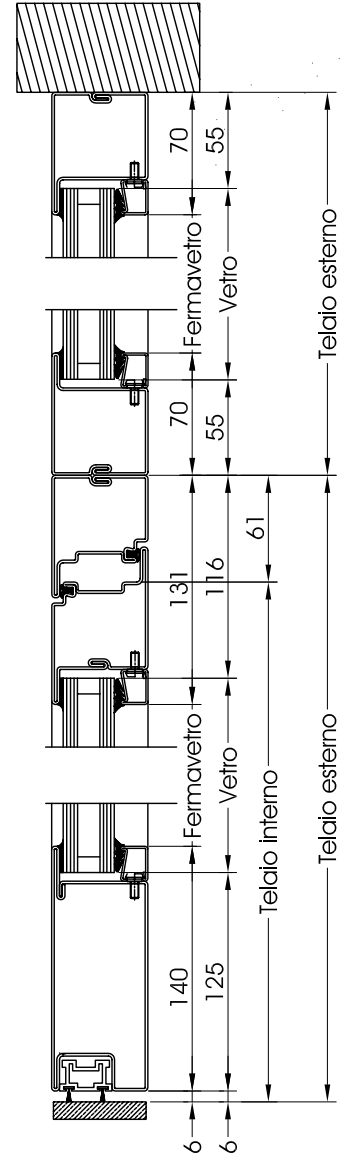

4

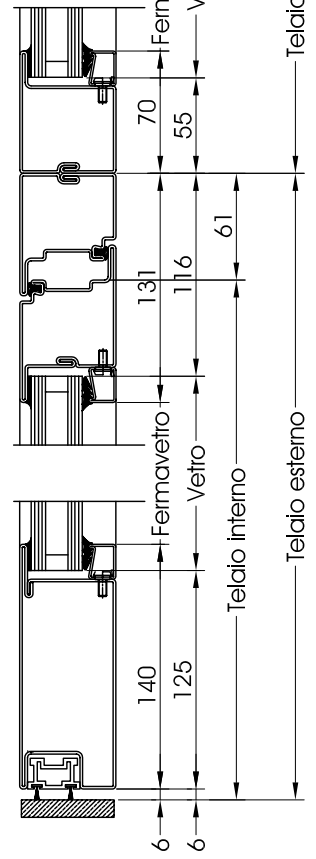

2

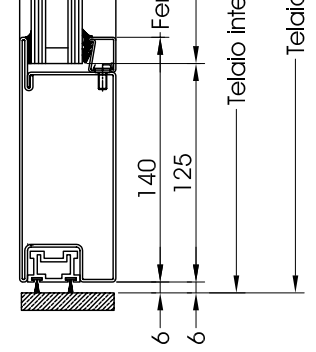

1 bis

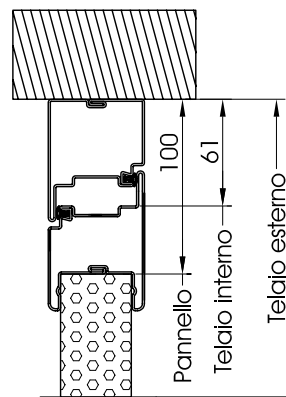

2 bis

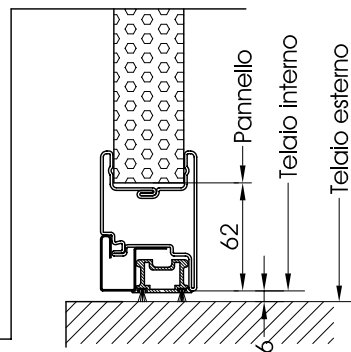

SEZIONI ORIZZONTALI: APERTURA INTERNA

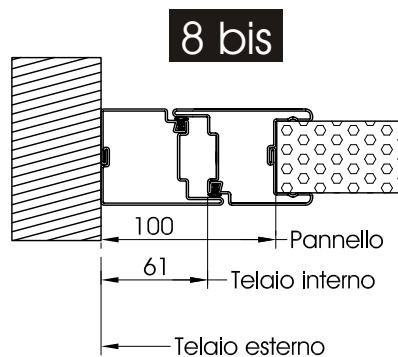
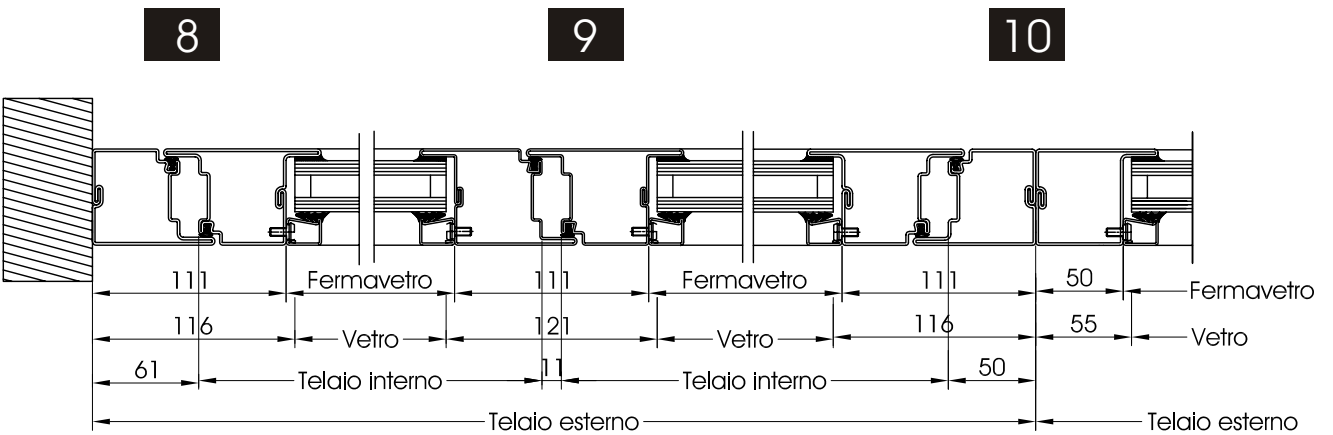
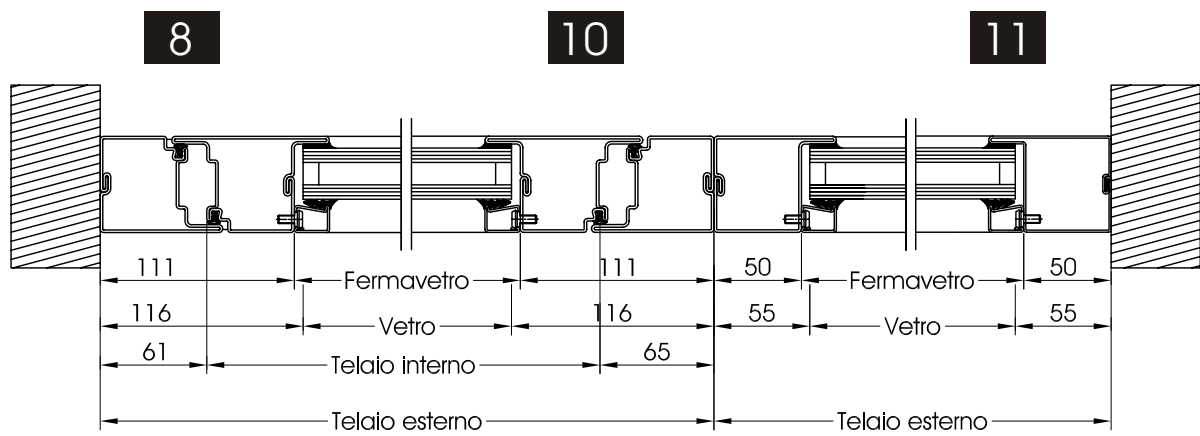
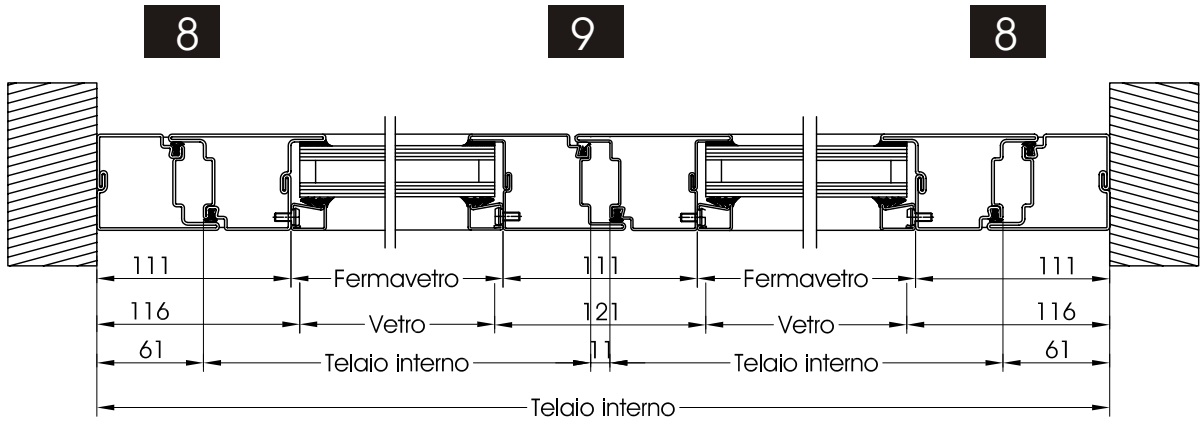

SPEEDY

SECCO

LISTA TIPOLOGIE PER PORTE AD APERTURA ESTERNA

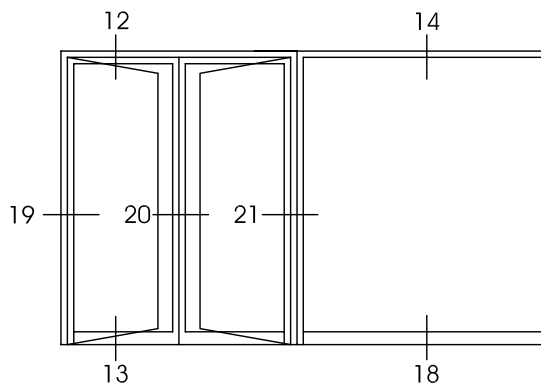
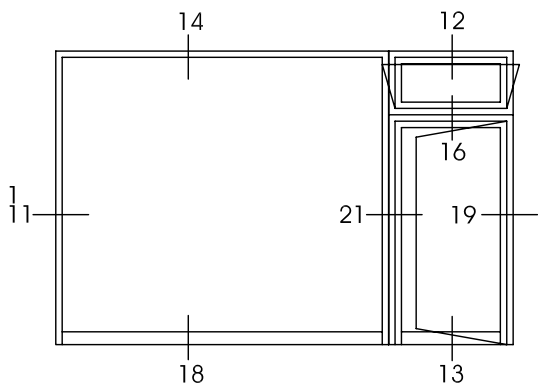
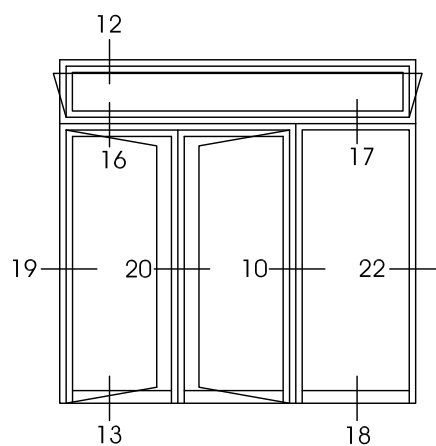
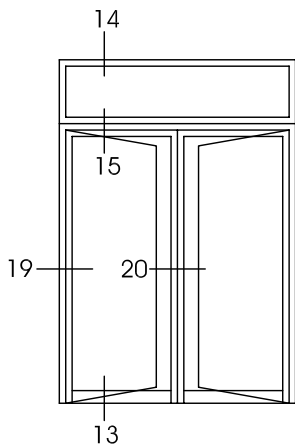
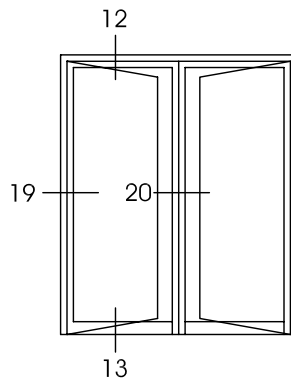
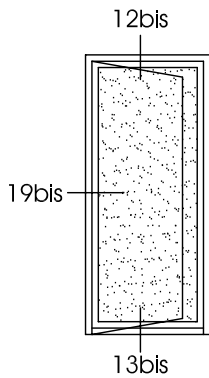
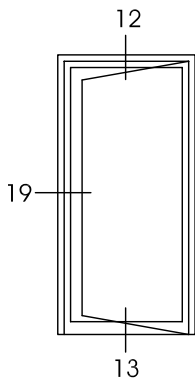

SECCO
SPEEDY

SEZIONI VERTICALI: APERTURA ESTERNA

12

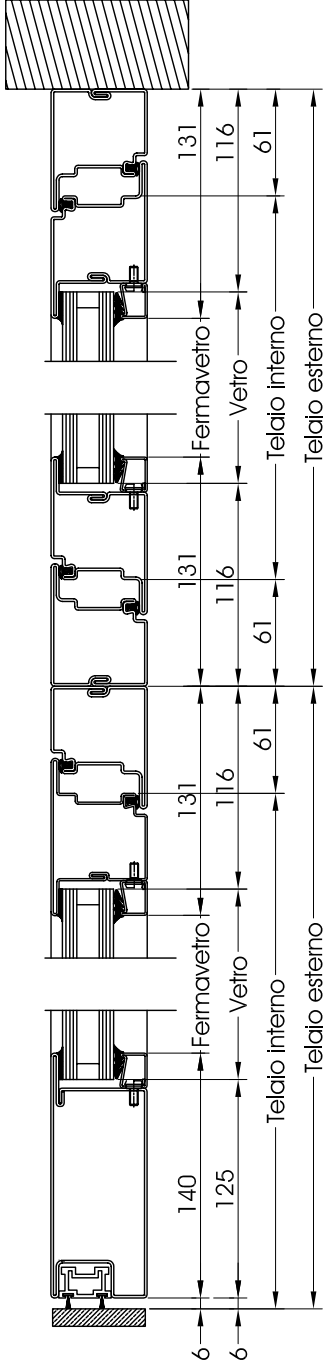

16

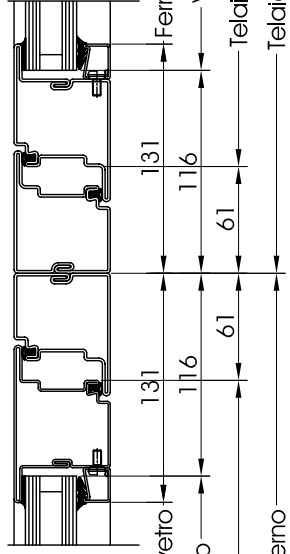

13

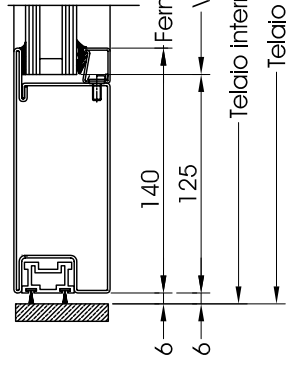

12

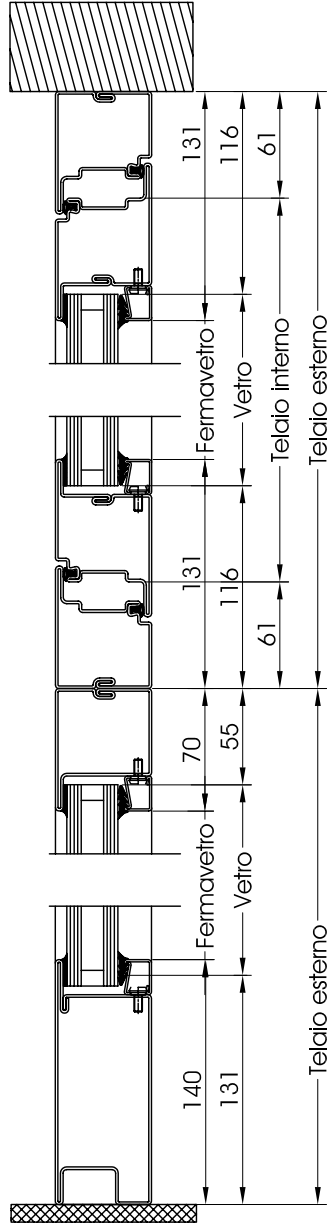

17

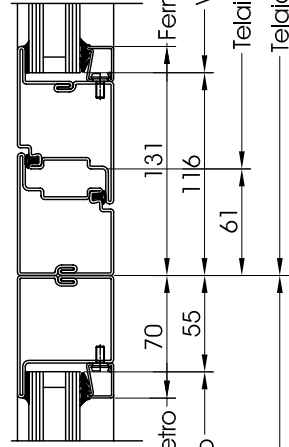

18

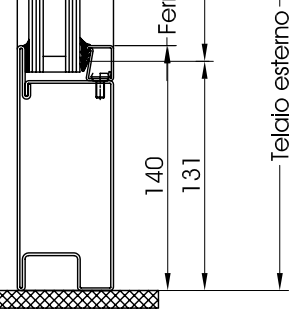

14

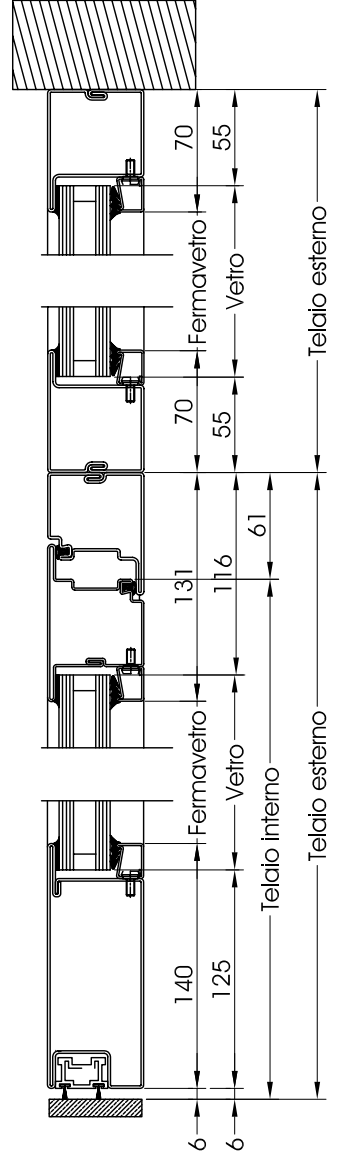

15

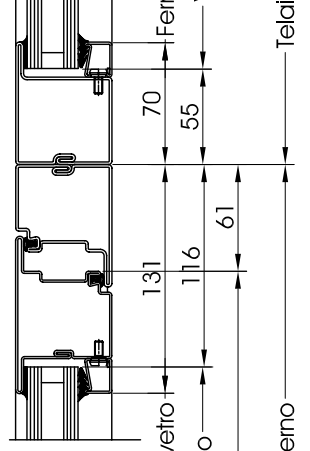

13

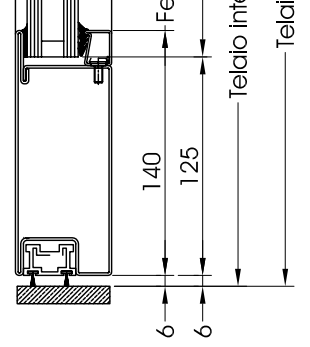

12 bis

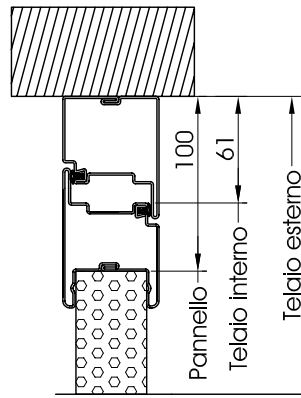

13 bis

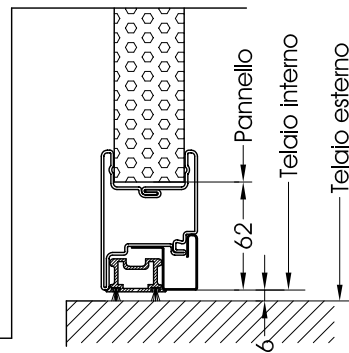

SPEEDY

SECCO

SEZIONI ORIZZONTALI: APERTURA ESTERNA

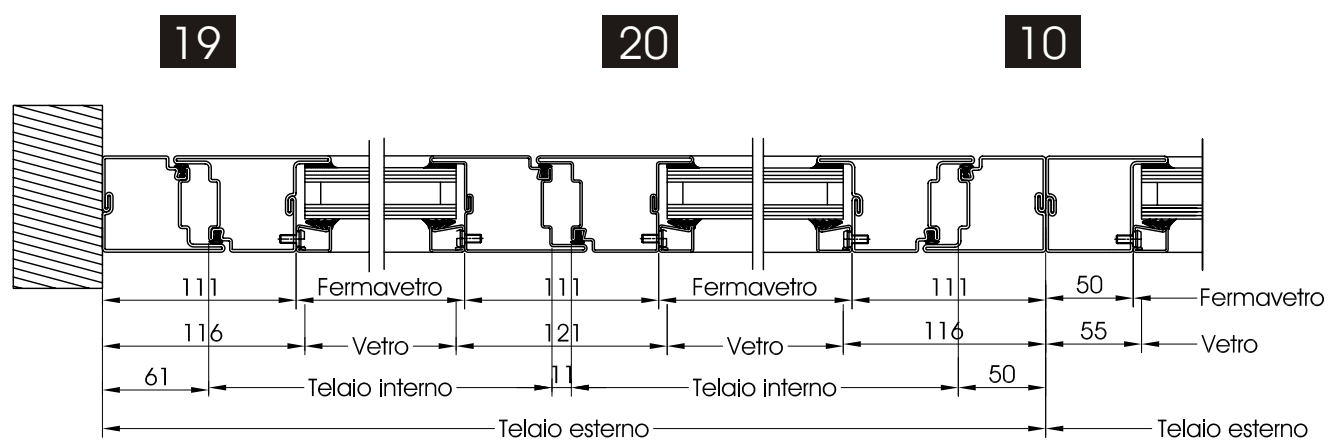
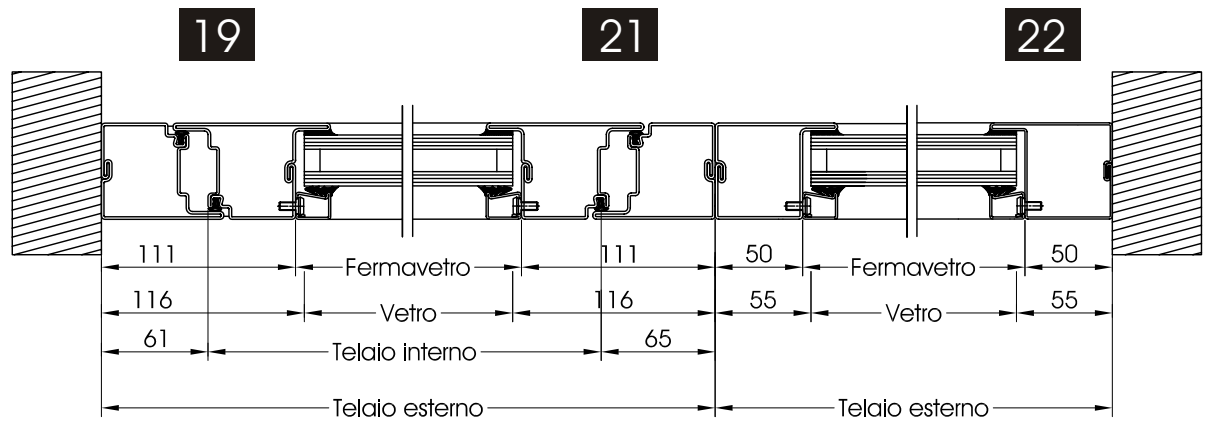
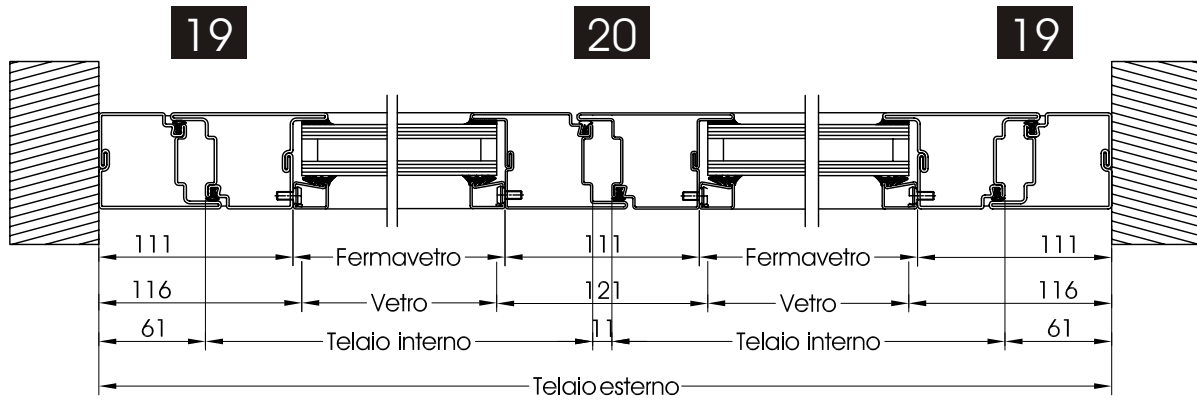

19 bis

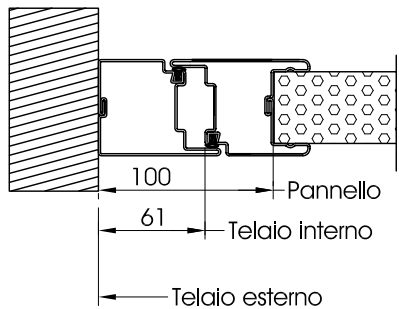

SECCO SPEEDY

SISTEMA DI FISSAGGIO CERNIERA AC6036

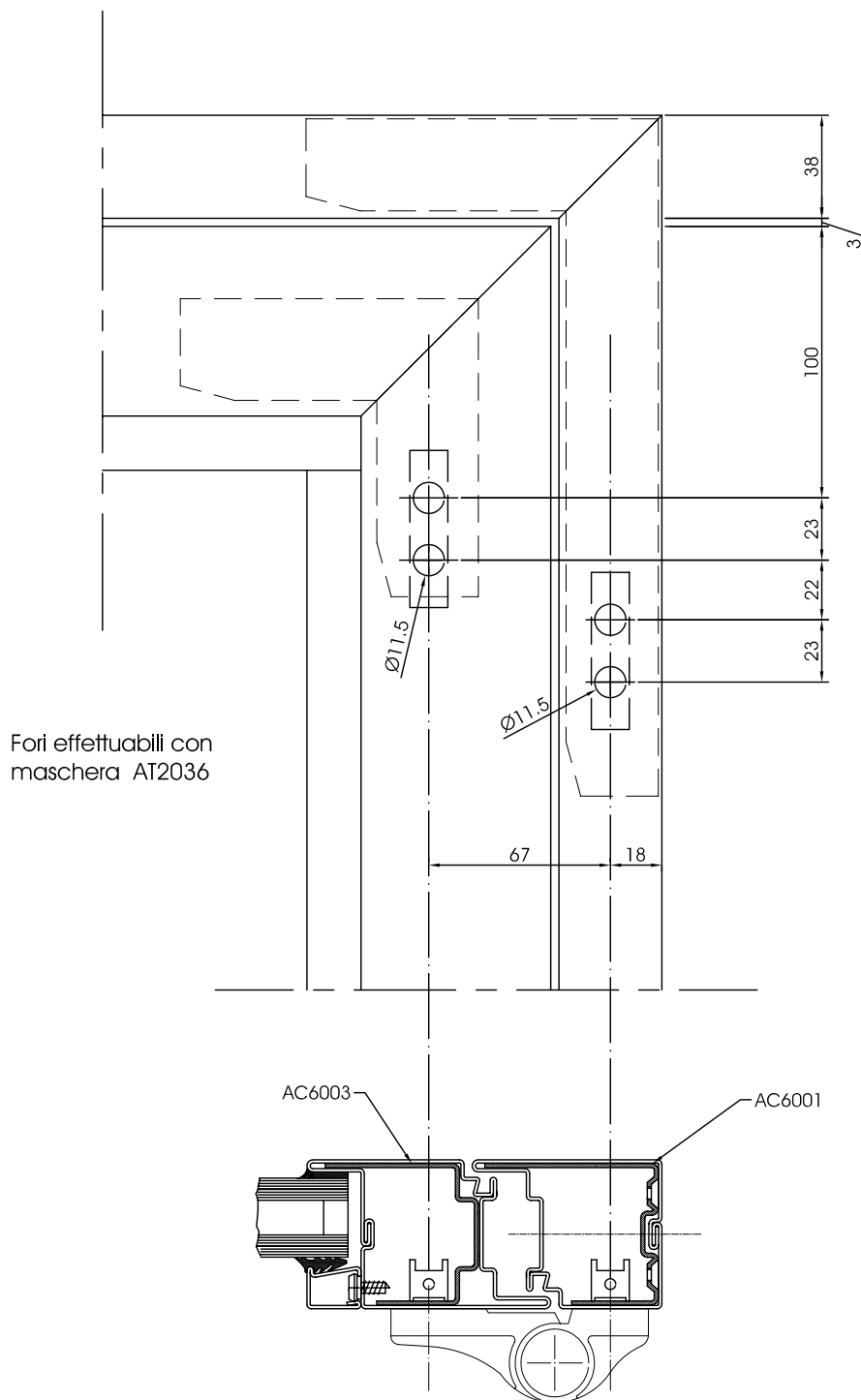

- * -La lavorazione può essere effettuata anche in posizioni intermedie della porta.
 -La lavorazione SX speculare alla DX
 -La lavorazione valida anche per aperture esterne

SPEEDY

SECCO

SISTEMA DI FISSAGGIO AC5029V

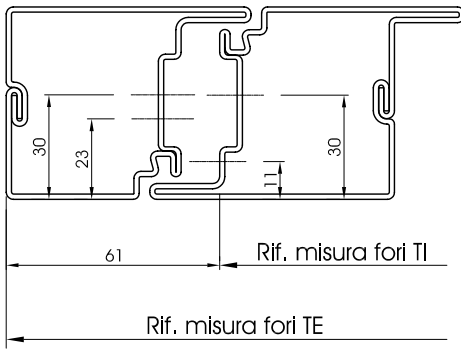

- * -La lavorazione può essere effettuata anche in posizioni intermedie della porta.
- La lavorazione SX speculare alla DX
- La lavorazione valida anche per aperture esterne

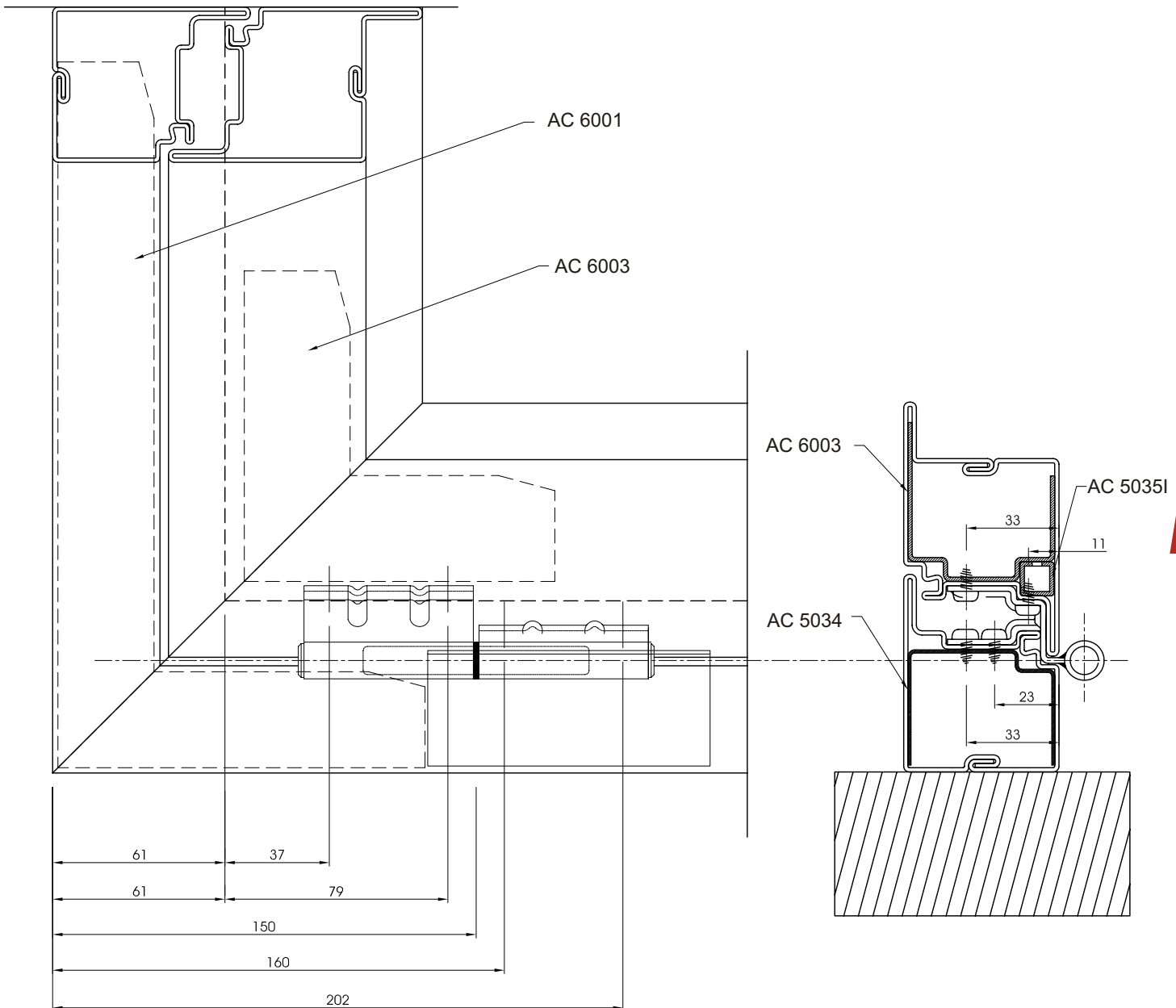

SPEEDY

SECCO

LAVORAZIONE TAGLIO PUNTA PER FISSAGGIO
FIORETTI AC 6014 AC 6013

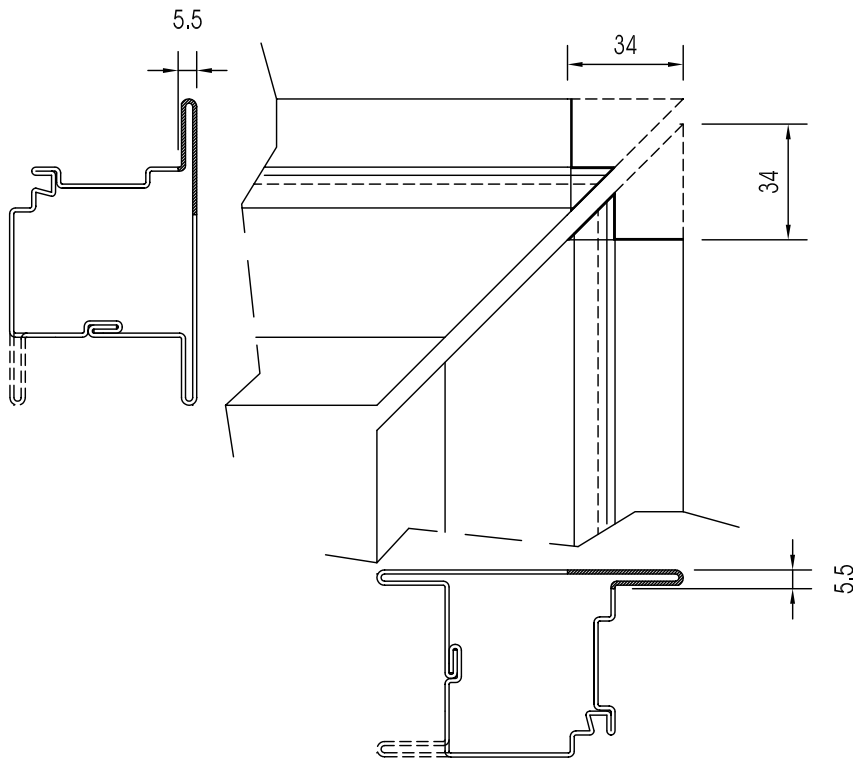

1

Effettuare la lavorazione nel profilo come da disegno

2

Posizionare i fioretti come da disegno

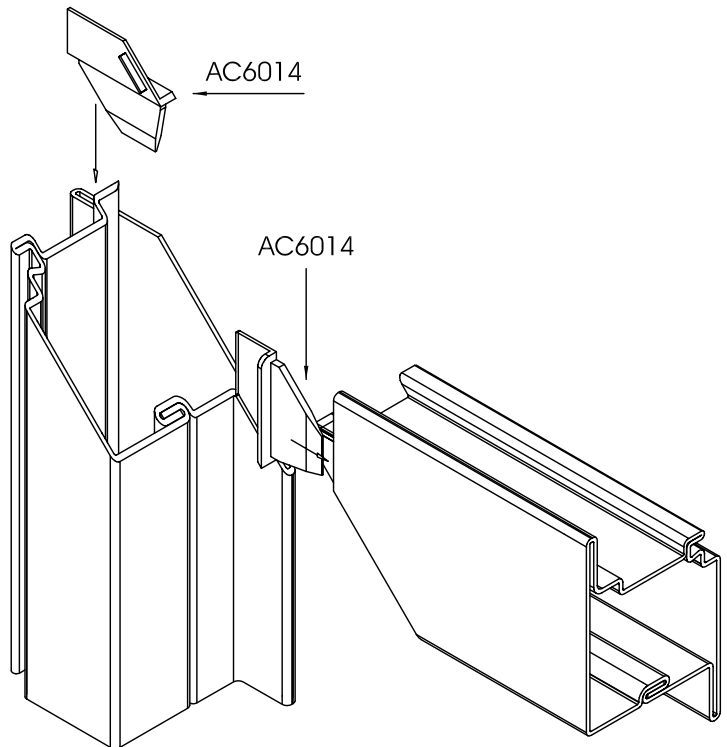

NB. = utilizzare AC6013 su angolo inferiore

SPEEDY

SECCO

LAVORAZIONI DI POSIZIONAMENTO, FORATURA E FISSAGGIO LIMITATORI AC5030

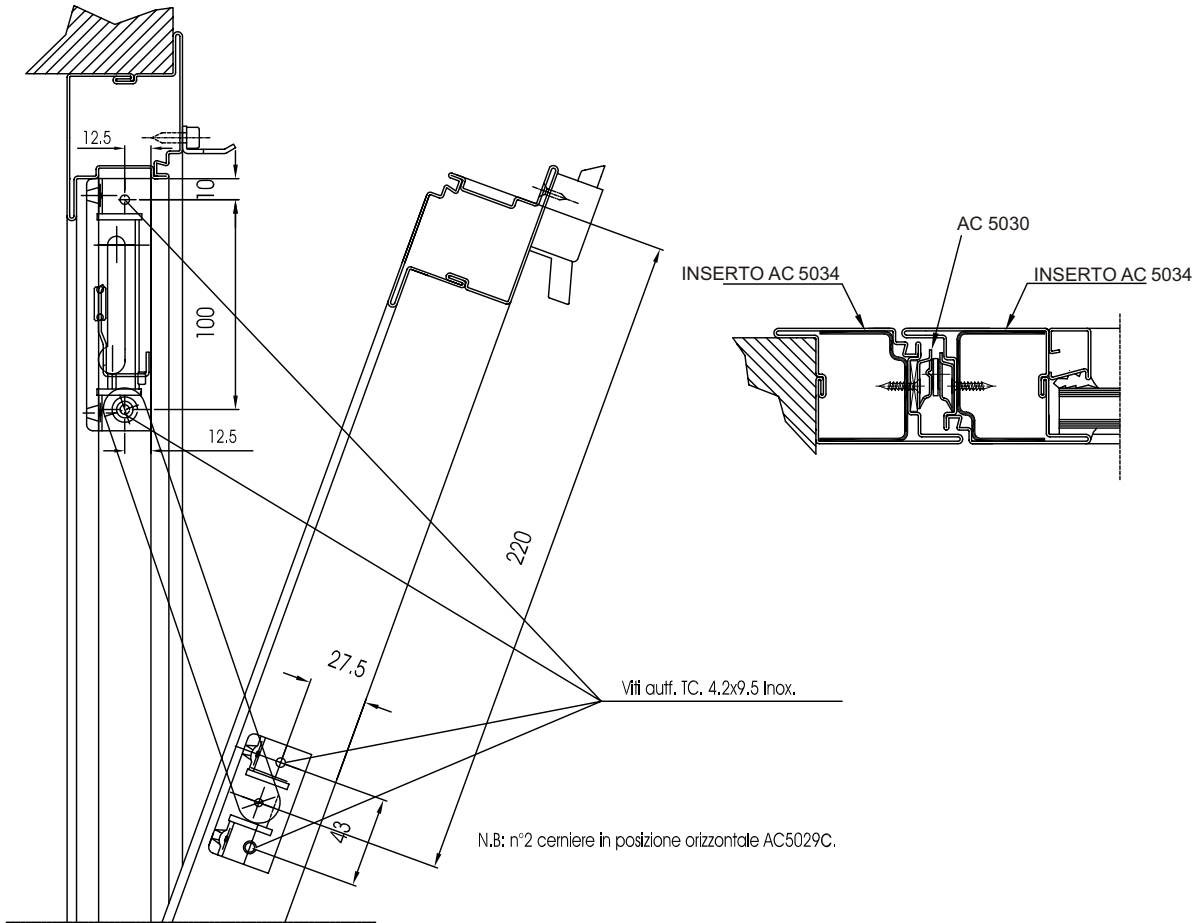

LAVORAZIONI DI POSIZIONAMENTO, FORATURA E FISSAGGIO CRICCHETTO AC5040

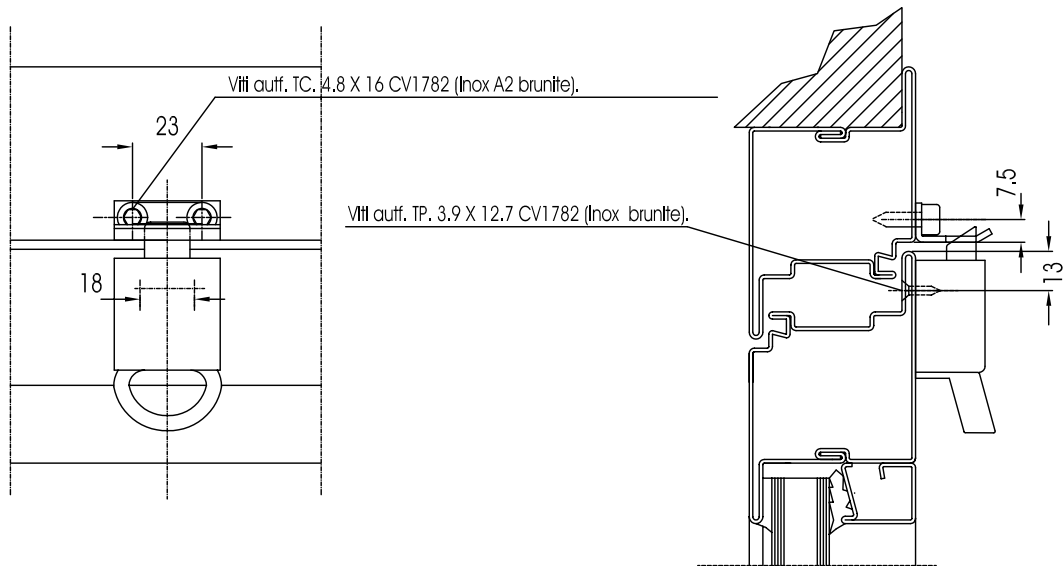

SECCO SPEEDY

**SIGILLATURE PER ASSEMBLAGGIO
ANGOLI - TRAVERSI - FASCIA- ZOCCOLO**

SPEEDY

SECCO

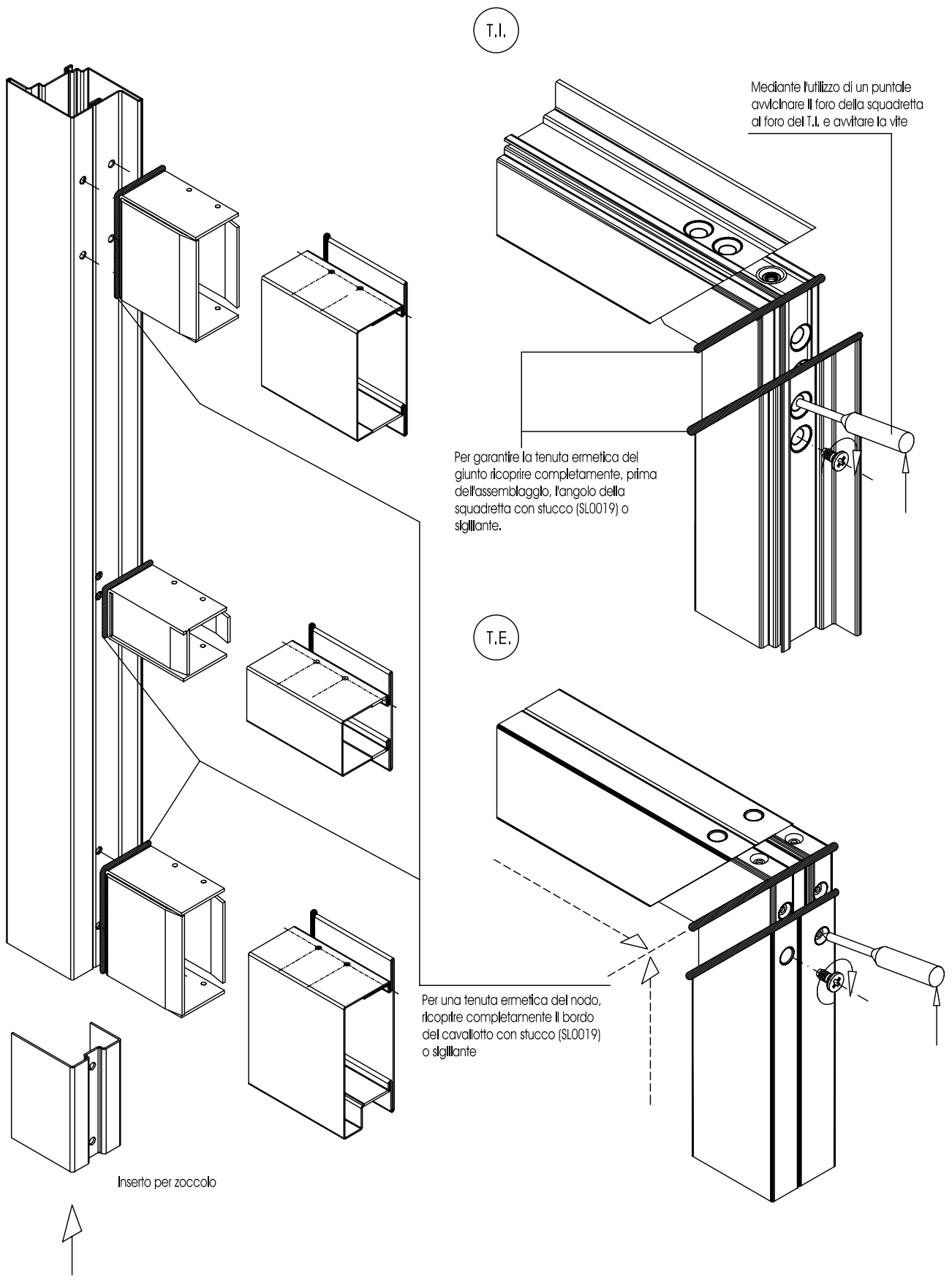

N.B.: Lavorazioni effettuabili con maschera AT2004

ASSIEMAGGIO PORTA PANNELLATA

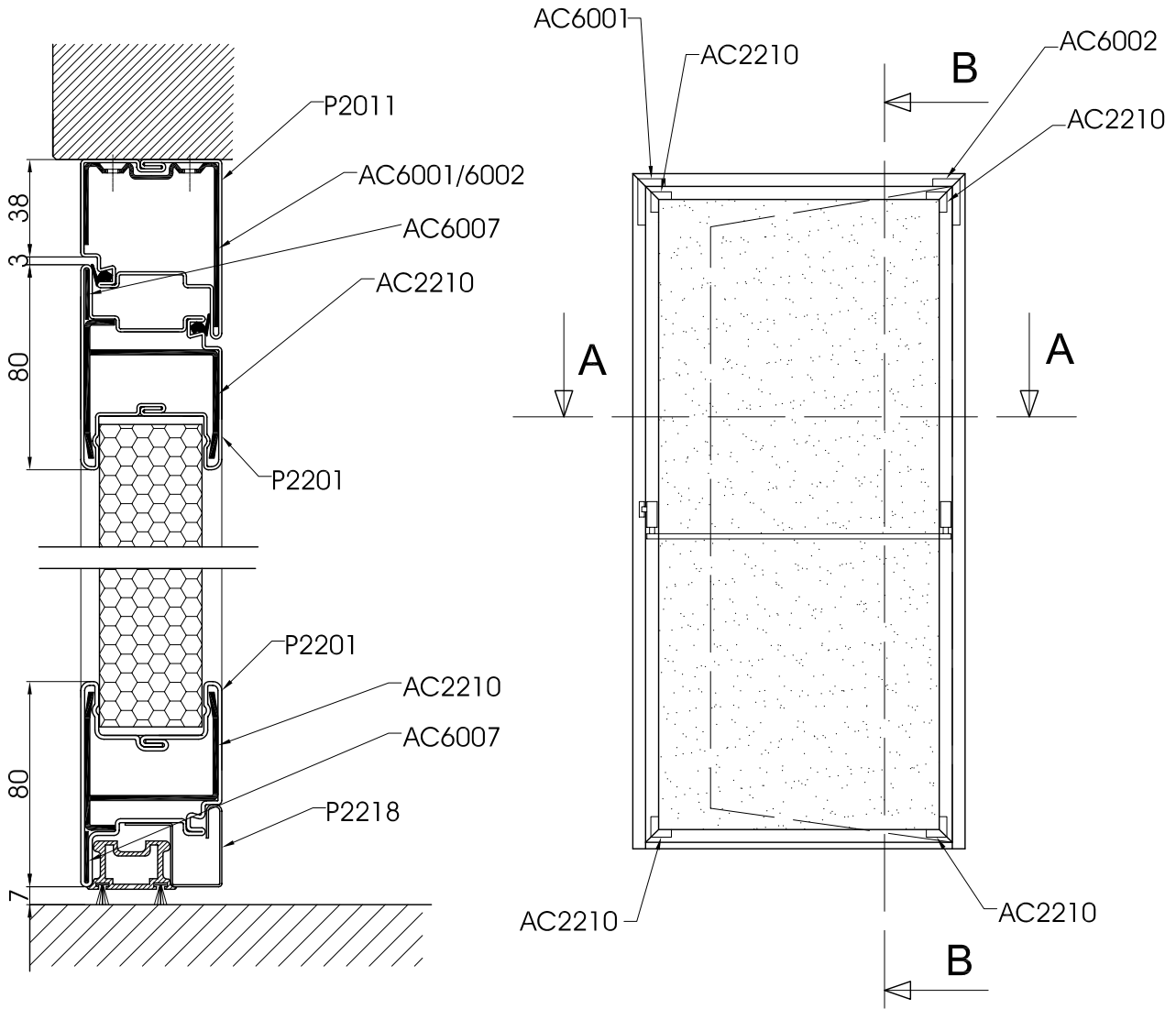

SEZ. B-B

SEZ. A-A

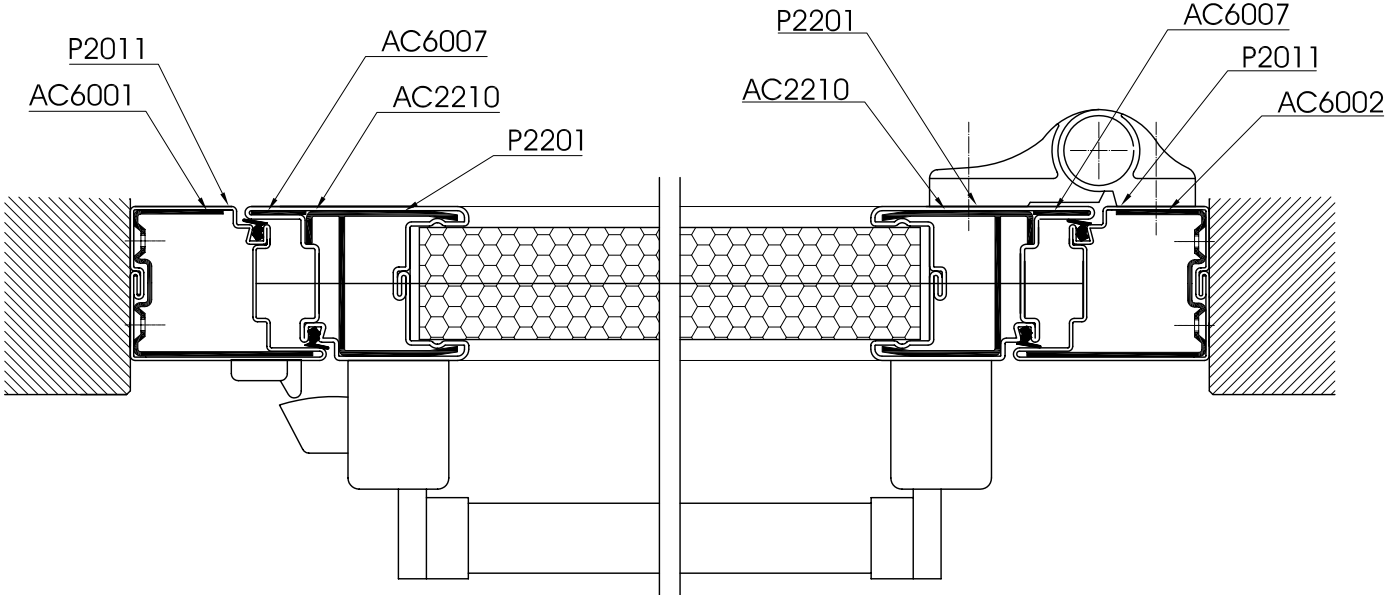

STAMPI E ATTREZZATURE

SPEEDY

SECCO

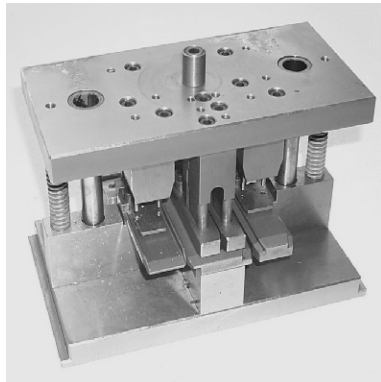

AT 1201

Stampo per lavorazione fori squadrette, asta cremonese e fissaggio cremonese per profili finestra.

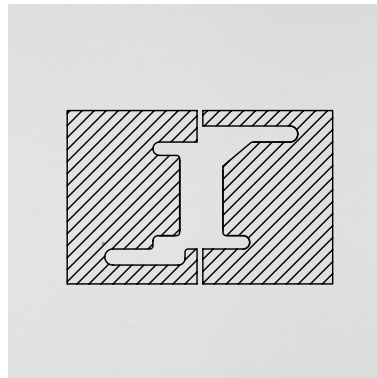

AT 1221

Ganascia per taglio profili P.4527 e P.4544

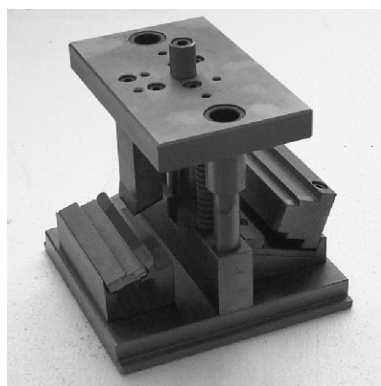

AT 1202

Stampo per lavorazione scarichi acqua apertura esterna e interna per profili finestra.

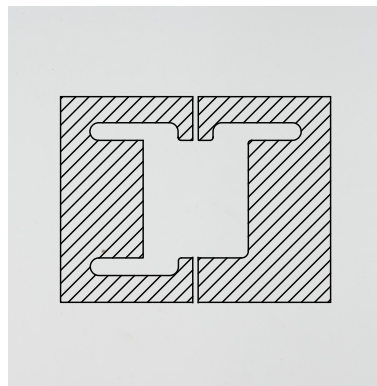

AT 1222

Ganascia per taglio profili P.4170 e P.4171.

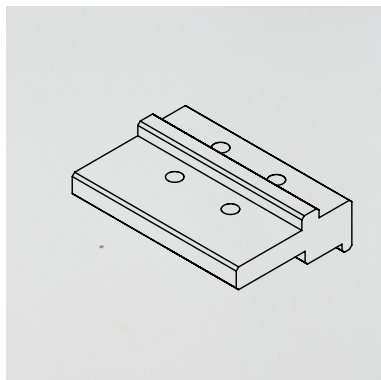

AT 1211

Maschera per esecuzione fori cerniere AC4350 e AC4350S

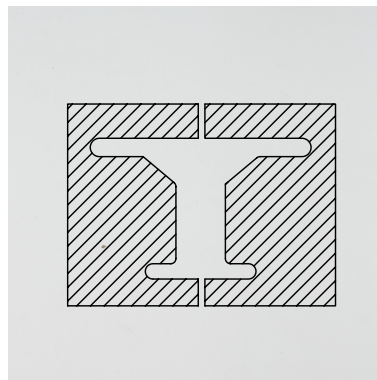

AT 1223

Ganascie per taglio profilo P.4528



AT 1212

Maschera per esecuzione fori fissaggio compassi wasistas e sporgere su T.I. e T.E. Per profili finestra.

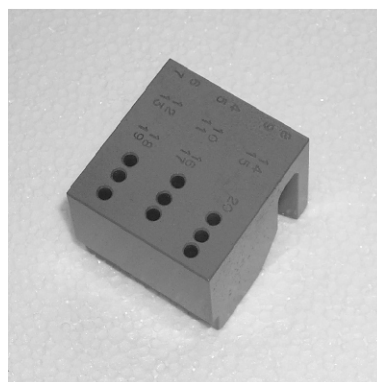

AT 1603

Maschera per esecuzione fori fissaggio fermavetri per profili finestra.

STAMPI E ATTREZZATURE

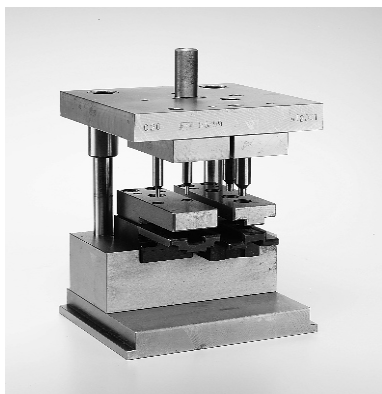

AT 2001
 Stampo per esecuzione fori fissaggio squadrette telaio interno ed esterno, per profili porte.

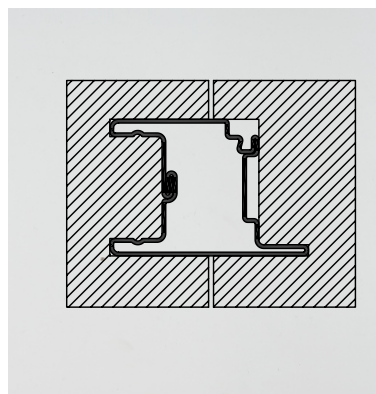

AT 2106
 Ganasce per taglio profilo P2201.

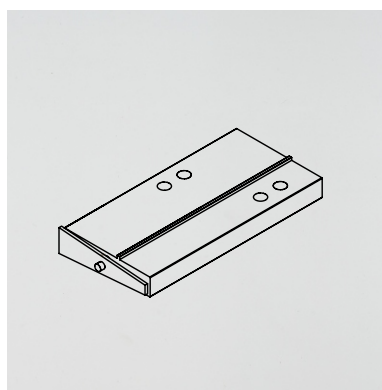

AT 2036
 Maschera per esecuzione fori fissaggio cerniere AC 6036.

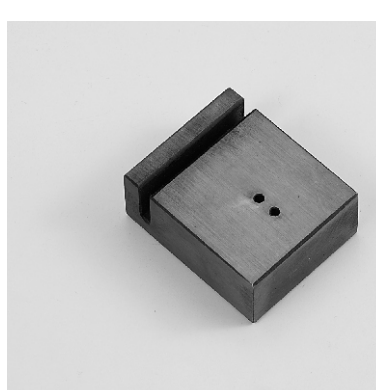

AT 5001
 Maschera per esecuzione fori di fissaggio fermavetri.

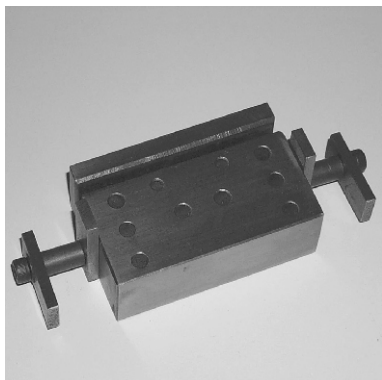

AT 2004
 Maschera per esecuzione fori di fissaggio cavalotti su profili fascia zoccolo e montanti.



MA 0301
 Pressa idraulica completa di supporto e pedaliera di comando atta ad eseguire le lavorazioni sui profilati "SECCO SISTEMI".
 -Forza Max.: 5000kg.
 -Dimensioni : 670 x 670 x 1800
 -Peso : 235 Kg.

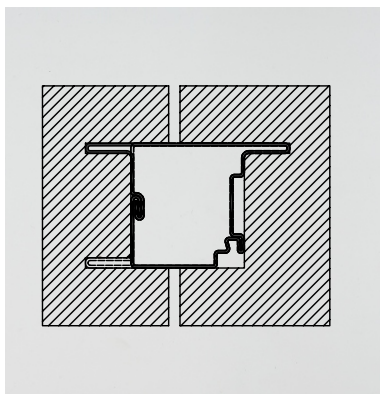

AT 2105
 Ganasce per taglio profili L, T e Z da 55.

SECCO SPEEDY

Sistema integrato di profilati, accessori ed attrezzature per la realizzazione di serramenti in acciaio verniciato con aperture ad anta, vasistas e sporgere.

PROFILATI ricavati mediante profilatura a freddo da nastro di acciaio zincato (sistema Sendzimir) con caratteristiche meccaniche non inferiori alla norma UNI EN 1042/3/7, con rivestimento minimo di zinco di 200 gr/mq sulle due facce, chiusi mediante unione meccanica ad alta resistenza.

ACCESSORI realizzati con materie prime di qualità. Gli accessori di movimento e di chiusura delle parti apribili sono corrispondenti alle prestazioni funzionali indicate nelle norme UNI 9158 app. C

ATTREZZATURE per la lavorazione dei profilati: ganasce sagomate per il taglio dei profilati; stampi per la realizzazione, mediante tranciatura, di asole e fori per l'assieme meccanico dei profilati e degli accessori; maschere ed attrezzature per lavorazioni complementari.

VERNICIATURA dei profilati. Trattamenti:

Preparazione del supporto, mediante 12 passaggi in vasche successive di trattamento e lavaggio; sgrassaggio alcalino, decapaggio acido, nitrocobaltazione, passivazione cromica, vari lavaggi intermedi.

Mano di fondo in cataforesi, che assicura una ottima adesione degli strati di verniciatura e una totale copertura di tutte le superfici esterne, spigoli compresi.

Mano a finire con polvere poliestere, particolarmente adatta per esterni, sia per il particolare sistema legante, che per il tipo di pigmenti e componenti dalla particolare resistenza alla luce, al calore e agli agenti atmosferici

Questo processo di protezione e verniciatura ed il rispetto delle metodologie di assemblaggio previste dalle note tecniche, garantiscono la continuità della protezione sulle zone soggette a lavorazioni meccaniche di taglio e punzonatura, in quanto i lembi della lavorazione meccanica sono protetti dall'azione galvanica dello zinco che si affaccia sul taglio.

Caratteristiche peculiari del sistema **FINESTRE**:

ROBUSTEZZA. La particolare forma dei profilati, con sezione da 46/52 mm, conferisce un'elevata robustezza al prodotto finito.

SORMONTO interno ed esterno tra ante e telaio.

GIUNTO esterno **APERTO**, con grande camera di compensazione e guarnizione di tenuta nel giunto interno, che garantisce elevate prestazioni di tenuta all'acqua, all'aria e al vento.

Caratteristiche peculiari del sistema **PORTE**:

ROBUSTEZZA. I profilati con sezione da 55 mm e spessore 12/10 mm, e il particolare sistema di unione dei telai, garantiscono una elevata robustezza al prodotto finito.

COMPLANARITA' delle ante interna ed esterna.

DOPPIA GUARNIZIONE DI TENUTA interna ed esterna nell'accoppiamento telaio interno - telaio esterno.

PROFILI CON CANALINA PORTA ACCESSORI a **CAMERA EUROPEA** che consente una notevole riduzione dei tempi di lavorazione.

